

FORTINATM LIGHTING

TECHNICAL GUIDE



1.800.350.4127
www.bnind.com

CONTENTS

VALENT® X	
Features and Benefits	4
Specifications	5
• Features/Ordering Codes	5
• Specification Table — 24V LightStrip	5
• Recommended Channels	6
• Mechanical Diagrams, Accessories, & Delivery Options	9
• Recommended Drivers	10
• Certifications & Warranty	11
VALENT® X EXTERIOR WET LOCATION	
Features and Benefits	13
Specifications	14
• Features/Ordering Codes	14
• Channel/Lens/Mounting Compatibility	15
• Recommended Channels	16
• Mechanical Diagrams, Accessories, & Delivery Options	18
• Recommended Drivers	19
• Certifications & Warranty	20
DRIVERS	
OMNIDRIVE® X Dimmable Hardwired Driver	
Features and Benefits	22
Commercial Grade Plug-In Adapter	
Features and Benefits	23

VALENT® X
HIGH-DENSITY LED TAPE LIGHT



VALENT® X

HIGH-DENSITY LED TAPE LIGHT

Precision-engineered, high-density tape light for demanding applications when light quality matters most. Up to 900+ lumens per foot with 95+ CRI/90+ R9.



24
VDC

95+
CRI

TITLE
24

FEATURES & BENEFITS

- Dense LED placement for uninterrupted linear light
- 95+ CRI/90+ R9
- Highest lumen output option

QUICK SPECS

VOLTAGE	24VDC
WIDTH	12mm
CRI	95+
WARRANTY	12 Year Limited Warranty
DIMMING	Dimmable
ENVIRONMENT	Indoor/Damp Location (IP20)
CERTIFICATION	UL Listed 2108
CONNECTOR	12mm Terminal Block

DI	VOLTAGE	MODEL	LUMEN SERIES	CCT	LENGTH
DI	24V (24VDC)	VLX	1 (100 Lumen Range)	20 (2000K) 35 (3500K)	016 (16.4 ft.)
			2 (200 Lumen Range)	22 (2200K) 40 (4000K)	100 (100 ft.)
			3 (300 Lumen Range)	24 (2400K) 50 (5000K)	
			5 (500 Lumen Range)	27 (2700K) 63 (6300K)	
			8 (800 Lumen Range)	30 (3000K)	

EXAMPLE: 24V VALENT® X 800 LUMENS 5000K 16.4 FT. SPOOL = **DI-24V-VLX8-50-016**

24VDC					
CCT	Lumens/ft.	Lumens/ft.	Lumens/ft.	Lumens/ft.	Lumens/ft.
2000K	104	194	299	-	-
2200K	104	194	299	-	-
2400K	104	194	299	469	730
2700K	101	207	311	495	782
3000K	106	218	323	557	853
3500K	108	218	328	586	906
4000K	112	228	342	534	806
5000K	116	242	365	592	840
6300K	112	244	363	578	924



VALENT® X HIGH-DENSITY LED TAPE LIGHT

Specification Sheet

VALENT® X HIGH-DENSITY LED TAPE LIGHT

Precision-engineered, high density tape light for demanding applications.
Up to 900+ lumens per foot with 95+ CRI / 90+ R9. 12 year warranty.

Date _____

Project Name _____



FEATURES

- Dense LED placement for uninterrupted linear light
- 100/200/300/500/800 lumen outputs
- 95+ CRI
- 1.32 inch cuttable increments
- Precision color rendering with 90+ R9 value
- Channel (extrusion) not required for heat sink
- 12 Year limited warranty

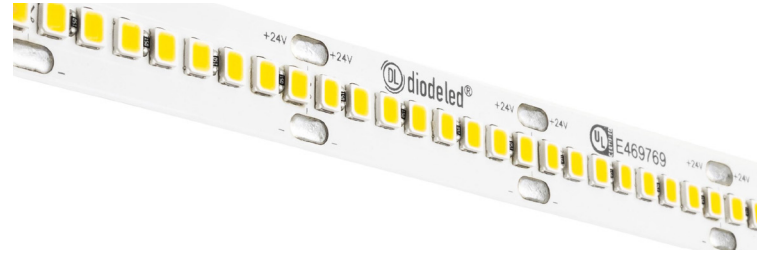

ORDERING CODES

Order spools, and components for field assembly

OPTIONAL ORDERING CODES

Add Length, Assembly Preferences, and Finish

	VOLTAGE	MODEL	CCTW	LENGTH	CHANNELS				FINISH	MOUNTING		DRIVER		DELIVERY
DI														
	24V	VLX1	24 (2400K) 40 (4000K)	016 (16.4 feet)	S1 (S1) 16 (16mm Square)	45DCO (45° Deco)	MI1 (2-inch Mud-In)	AL (Aluminum)	3M (3M Adhesive)	VC (Vertical Clip)	ELV (Electronic)	LUT (Lutron)	Field Assembly	
		VLX2	27 (2700K) 50 (5000K)	100 (100 feet)	S2 (S2) RC20 (20mm Round)	90 (90° Sideview)	REC (Recessed)	BL (Black)	MC (Mounting Clip)	HNG (Hanging Hardware)	VLM (Constant Voltage)	SWX (Switchex)	Factory + Field (Hybrid)	
		VL3	30 (3000K) 63 (6300K)		S45 (S45) SQ20 (20mm Square)	REF (Reflector)	WF (Waveform)	WH (White)	UC (U-Clip)	RC (Rotating Clip)	O/O (On/Off)	PoE (Power Over Ethernet)	Factory Assembly	
		VLX5	35 (3500K)		SL (Slim) SQ (Square)	ROD (Rod)								
		VLX8			CA (Canal) 45 (45°)	MI1 (1-inch Mud-in)								

24V VALENT® X SPECIFICATION TABLE

MODEL	24V-VLX1	24V-VLX2	24V-VLX3	24V-VLX5	24V-VLX8
VOLTAGE	24VDC	24VDC	24VDC	24VDC	24VDC
WATTAGE	1W/ft.	1.9W/ft.	2.8W/ft.	4.6W/ft.	7.2W/ft.
2400k	104 Lm/ft.	194 Lm/ft.	299 Lm/ft.	469 Lm/ft.	730 Lm/ft.
2700k	101 Lm/ft.	207 Lm/ft.	311 Lm/ft.	495 Lm/ft.	782 Lm/ft.
3000k	106 Lm/ft.	218 Lm/ft.	323 Lm/ft.	557 Lm/ft.	853 Lm/ft.
Lumens 3500k	108 Lm/ft.	218 Lm/ft.	328 Lm/ft.	586 Lm/ft.	906 Lm/ft.
4000k	112 Lm/ft.	228 Lm/ft.	342 Lm/ft.	534 Lm/ft.	806 Lm/ft.
5000k	116 Lm/ft.	242 Lm/ft.	365 Lm/ft.	592 Lm/ft.	840 Lm/ft.
6300k	112 Lm/ft.	244 Lm/ft.	363 Lm/ft.	578 Lm/ft.	924 Lm/ft.
Cut Points	1.32 in.	1.32 in.	1.32 in.	1.32 in.	1.32 in.
Max Run (ft.)	80 ft.	53 ft.	41 ft.	30 ft.	19 ft.
Max Run (Class 2)	80 ft.	53 ft.	41 ft.	25 ft.	14 ft.
CRI	95+	95+	95+	95+	95+
Dimensions	0.47 x 0.1 in. (W x H)	0.47 x 0.1 in. (W x H)	0.47 x 0.1 in. (W x H)	0.47 x 0.1 in. (W x H)	0.47 x 0.1 in. (W x H)
TM-30 (LM-80)	>50,000 hours	>50,000 hours	>50,000 hours	>50,000 hours	>50,000 hours
Environment	Indoor / Damp Location (IP20)	Indoor / Damp Location (IP20)	Indoor / Damp Location (IP20)	Indoor / Damp Location (IP20)	Indoor / Damp Location (IP20)
Ambient Temperature	-4 ~ 122°F (-20 ~ 50°C)	-4 ~ 122°F (-20 ~ 50°C)	-4 ~ 122°F (-20 ~ 50°C)	-4 ~ 122°F (-20 ~ 50°C)	-4 ~ 122°F (-20 ~ 50°C)
Operating Temperature	-4 ~ 176°F (-20 ~ 80°C)	-4 ~ 176°F (-20 ~ 80°C)	-4 ~ 176°F (-20 ~ 80°C)	-4 ~ 176°F (-20 ~ 80°C)	-4 ~ 176°F (-20 ~ 80°C)
LED Chips	72/ft.	72/ft.	72/ft.	72/ft.	72/ft.
Chip Type	2835	2835	2835	2835	2835
Certification	UL Listed 2108	UL Listed 2108	UL Listed 2108	UL Listed 2108	UL Listed 2108
Warranty	12 year	12 year	12 year	12 year	12 year

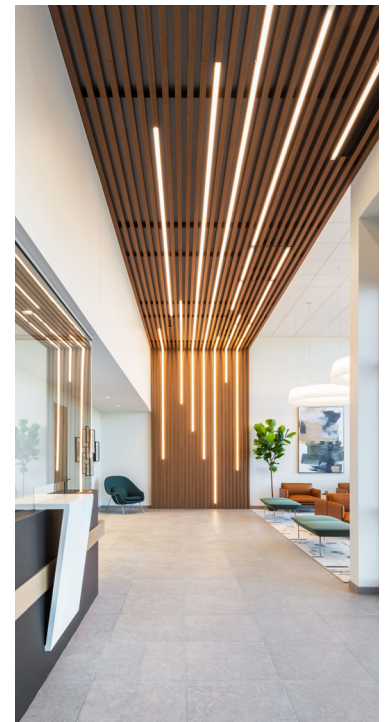



VALENT® X HIGH-DENSITY LED TAPE LIGHT

Specification Sheet

Date _____

Project Name _____

VALENT® X HIGH-DENSITY LED TAPE LIGHT

Precision-engineered, high density tape light for demanding applications.
Up to 900+ lumens per foot with 95+ CRI / 90+ R9. 12 year warranty.

12
Year
Warranty

IP20

24
VDC

FOR A & B RANGES
CLOSET RATED

TITLE
24

24V VALENT® X RECOMMENDED CHANNELS

MODEL	DIAGRAM	INCLUDED ACCESSORIES	CONNECTION OPTIONS	IN CHANNEL DIFFUSION	TECHNICAL RATINGS	MOUNTING OPTIONS WITH DIMENSIONS
S1 Channel DI-CHB-S1 (S1) 48", 96" Aluminum <small>For 14mm Tape Light or Smaller</small>	Height (H): 0.31 in. Width (W): 0.67 in. Interior Depth (ID): 0.25 in. Interior Width (IW): 0.58 in. 	48 in. channel & frosted cover 2x surface mounting clips End caps: 1x open, 1x closed.	12mm Tape Light: Soldered Lead Only	Classic Frosted Lens VLX1, VLX2, VLX3, VLX5, VLX8: Dotless	<ul style="list-style-type: none"> Beam Angle: 120° Classic Frosted Lens Light Loss: 20% CCT Shift: -40K IP Rating Shift: IP40 	 U-Clip: 0.32 x 0.68 in. (H x W)
S2 Channel DI-CHB-S2 (S2) 48", 96" Aluminum <small>For 14mm Tape Light or Smaller</small>	Height (H): 0.57 in. Width (W): 0.74 in. Interior Depth (ID): 0.34 in. Interior Width (IW): 0.63 in. 	48 in. Channel & Frosted Lens, 1 open end cap, 1 closed end cap, 2 mounting clips, 2 mounting screws 96 in. Channel & Frosted Lens, 2 open end cap, 2 closed end cap, 4 mounting clips, 4 mounting screws	12mm Terminal Block Compatible	Classic Frosted Lens VLX1, VLX2, VLX3, VLX5, VLX8: Dotless	<ul style="list-style-type: none"> Beam Angle: 120° Classic Frosted Lens Light Loss: 20% CCT Shift: -40K IP Rating Shift: IP40 	 U-Clip: 0.58 x 0.75 in. (H x W)
S45 Channel DI-CHB-S45 (S45) 48", 96" Aluminum <small>For 14mm Tape Light or Smaller</small>	Height (H): 0.78 in. Width (W): 0.74 in. Interior Depth (ID): 0.54 in. Interior Width (IW): 0.6 in. 	48 in. Channel & Frosted Lens, 1 open end cap, 1 closed end cap, 2 mounting clips, 2 mounting screws 96 in. Channel & Frosted Lens, 2 open end cap, 2 closed end cap, 4 mounting clips, 4 mounting screws	12mm Terminal Block Compatible	Classic Frosted Lens VLX1, VLX2, VLX3, VLX5, VLX8: Dotless	<ul style="list-style-type: none"> Beam Angle: 120° Classic Frosted Lens Light Loss: 20% CCT Shift: -40K IP Rating Shift: IP40 	 U-Clip: 0.79 x 0.79 in. (H x W)
Slim Channel DI-CPCHB-SL (SL) 48", 96" Aluminum, White, Black <small>For 14mm Tape Light or Smaller</small>	Height (H): 0.38 in. Width (W): 0.82 in. Interior Depth (ID): 0.3 in. Interior Width (IW): 0.67 in. 	48" Aluminum, Black, & White Channels <ul style="list-style-type: none"> 48 in. channel & lens 2x surface mounting clips End caps: 1x open, 1x closed 96" Aluminum, Black, & White Channels <ul style="list-style-type: none"> 96 in. channel & lens 4x surface mounting clips End caps: 2x open, 2x closed 	12mm Terminal Block Compatible	Architectural Frosted Lens VLX1, VLX2, VLX3, VLX5, VLX8: Dotless Premium Diffusion Lens VLX1, VLX2, VLX3, VLX5, VLX8: Dotless For diffusion options not listed, refer to Slim Channel Specification Sheet.	<ul style="list-style-type: none"> Beam Angle: 120° Architectural Clear Lens Light Loss: 10% CCT Shift: -20K Architectural Frosted Lens Light Loss: 20% CCT Shift: -35K Classic Frosted Lens Light Loss: 20% CCT Shift: -40K Black Lens Light Loss: 90% CCT Shift: -350K Premium Diffusion Lens Light Loss: 10% CCT Shift: -30K IP Rating Shift: IP40 	 1. Slim Mount: 0.54 x 0.87 in. (H x W) 2. 3M Adhesive: 0.48 x 0.82 in. (H x W) 3. Magnetic U-Clip: 0.59 x 0.82 in. (H x W) 4. Premium Diffusion: 0.96 x 0.82 in. (H x W)
Canal Channel DI-CPCHB-CAN (CA) 48", 96" Aluminum, White, Black <small>For 14mm Tape Light or Smaller</small>	Height (H): 0.59 in. Width (W): 0.69 in. Interior Depth (ID): 0.54 in. Interior Width (IW): 0.61 in. 	48" Aluminum, Black, & White Channels <ul style="list-style-type: none"> 48 in. channel & opal lens 2x surface mounting clips End caps: 1x open, 1x closed. 96" Aluminum, Black, & White Channels <ul style="list-style-type: none"> 96 in. channel & opal lens 4x surface mounting clips End caps: 2x open, 2x closed. 	12mm Tape Light: Soldered Lead Only	Opal Lens VLX1, VLX2, VLX3, VLX5, VLX8: Dotless	<ul style="list-style-type: none"> Beam Angle: 120° Opal Lens Light Loss: 55% CCT Shift: -200K IP Rating Shift: IP40 	 U-Clip: 0.6 x 0.7 in. (H x W)
16mm Square Channel DI-CPCHB-16MM (16) 48", 96" Aluminum <small>For 14mm Tape Light or Smaller</small>	Height (H): 0.89 in. Width (W): 0.77 in. Interior Width (IW): 0.63 in. 	48 in. channel & Architectural Frosted Lens <ul style="list-style-type: none"> 2x surface mounting clips End caps: 1x open, 1x closed. 96 in. channel & Architectural Frosted Lens <ul style="list-style-type: none"> 4x surface mounting clips End caps: 2x open, 2x closed. 	12mm Terminal Block Compatible	Architectural Frosted Lens VLX1, VLX2, VLX3, VLX5, VLX8: Dotless	<ul style="list-style-type: none"> Beam Angle: 120° Architectural Frosted Lens Light Loss: 20% CCT Shift: -35K Black Lens Light Loss: 90% CCT Shift: -350K IP Rating Shift: IP40 	 Mounting Clip: 0.89 x 0.77 in. (H x W)



VALENT® X HIGH-DENSITY LED TAPE LIGHT

Specification Sheet

Date _____

Project Name _____

VALENT® X HIGH-DENSITY LED TAPE LIGHT

Precision-engineered, high density tape light for demanding applications.
Up to 900+ lumens per foot with 95+ CRI / 90+ R9. 12 year warranty.



24V VALENT® X RECOMMENDED CHANNELS

MODEL	DIAGRAM	INCLUDED ACCESSORIES	CONNECTION OPTIONS	IN CHANNEL DIFFUSION	TECHNICAL RATINGS	MOUNTING OPTIONS WITH DIMENSIONS
20mm Round Channel DI-CPCHB-RC20 (RC20) 48", 96" Aluminum For 14mm Tape Light or Smaller	Height (H): 1.18 in. Width (W): 1.18 in. Interior Width (IW): 0.84 in.	48 in. channel & frosted lens 2x surface mounting clips End caps: 1x open, 1x closed. 96 in. channel & frosted lens 4x surface mounting clips End caps: 2x open, 2x closed.	12mm Terminal Block Compatible 	Classic Frosted Lens VLX1, VLX2, VLX3, VLX5, VLX8: Dotless	<ul style="list-style-type: none"> Beam Angle: 180° Classic Frosted Lens Light Loss: 20% CCT Shift: -40K IP Rating Shift: IP40 	 U-Clip: 1.19 x 1.19 in. (H x W)
20mm Square Channel DI-CPCHB-SQC20 (SQ20) 48", 96" Aluminum For 14mm Tape Light or Smaller	Height (H): 1.18 in. Width (W): 1.18 in. Interior Width (IW): 0.84 in.	48 in. channel & frosted lens 2x surface mounting clips End caps: 1x open, 1x closed. 96 in. channel & frosted lens 4x surface mounting clips End caps: 2x open, 2x closed.	12mm Terminal Block Compatible 	Classic Frosted Lens VLX1, VLX2, VLX3, VLX5, VLX8: Dotless	<ul style="list-style-type: none"> Beam Angle: 180° Classic Frosted Lens Light Loss: 20% CCT Shift: -40K IP Rating Shift: IP40 	 U-Clip: 1.19 x 1.19 in. (H x W)
Square Channel DI-CPCHB-SQ (SQ) 48", 96" Aluminum, White, Black For 14mm Tape Light or Smaller	Height (H): 0.55 in. Width (W): 0.82 in. Interior Depth (ID): 0.27 in. Interior Width (IW): 0.67 in.	48" Aluminum Channel <ul style="list-style-type: none"> 48 in. channel & frosted cover Mounting hardware End caps: 1x open, 1x closed. 48" Black & White Channels 48 in. channel & clear, or frosted lens <ul style="list-style-type: none"> 4x surface mounted clips 2x End-to-end interconnects 96" Aluminum Channel <ul style="list-style-type: none"> 96 in. channel & frostedcover Mounting hardware End caps: 2x open, 2x closed. 96" Black & White Channels <ul style="list-style-type: none"> 96 in. channel & clear, or frosted lens 4x surface mounted clips 2x End-to-end interconnects 	12mm Terminal Block Compatible 	Architectural Frosted Lens VLX1, VLX2, VLX3, VLX5, VLX8: Dotless Premium Diffusion Lens VLX1, VLX2, VLX3, VLX5, VLX8: Dotless For diffusion options not listed, refer to Square Channel Specification Sheet.	<ul style="list-style-type: none"> Beam Angle: 120° Architectural Clear Lens Light Loss: 10% CCT Shift: -20K Architectural Frosted Lens Light Loss: 20% CCT Shift: -35K Classic Frosted Lens Light Loss: 20% CCT Shift: -40K Black Lens Light Loss: 90% CCT Shift: -350K Premium Diffusion Lens Light Loss: 10% CCT Shift: -30K IP Rating Shift: IP40 	 1. Chromapath Surface Mount: 0.61 x 0.82 in. (H x W) 2. Vertical Mount: 0.61 x 0.82 in. (H x W) 3. Rotating Mount: 1.29 x 0.82 (H x W) 4. Hanging Mount: 1.51 x 0.82 in. (H x W) 5. Premium Diffusion: 1.13 x 0.82 in. (H x W)
45° Channel DI-CPCHB-45 (45) 48", 96" Aluminum, White, Black For 14mm Tape Light or Smaller	Height (H): 0.94 in. Width (W): 0.67 in. Interior Depth (ID): 0.32 in. Interior Width (IW): 0.67 in.	48" Aluminum, Black, & White Channels <ul style="list-style-type: none"> 48 in. channel & clear, or frosted lens 4x surface mounted clips 2x End-to-end interconnects 96" Aluminum Channel <ul style="list-style-type: none"> 96 in. channel & clear, or frosted lens 8x surface mounted clips 4x End-to-end interconnects 96" Black & White Channels <ul style="list-style-type: none"> 96 in. channel & clear, or frosted lens 4x surface mounted clips 2x End-to-end interconnects 	12mm Terminal Block Compatible 	Architectural Frosted Lens VLX1, VLX2, VLX3, VLX5, VLX8: Dotless Premium Diffusion Lens VLX1, VLX2, VLX3, VLX5, VLX8: Dotless For diffusion options not listed, refer to 45° Channel Specification Sheet.	<ul style="list-style-type: none"> Beam Angle: 120° Architectural Clear Lens Light Loss: 10% CCT Shift: -20K Architectural Frosted Lens Light Loss: 20% CCT Shift: -35K Classic Frosted Lens Light Loss: 20% CCT Shift: -40K Black Lens Light Loss: 90% CCT Shift: -350K Premium Diffusion Lens Light Loss: 10% CCT Shift: -30K IP Rating Shift: IP40 	 1. Chromapath Surface Mount: 1 x 0.67 in. (H x W) 2. Vertical Mount: 1 x 0.67 in. (H x W) 3. Rotating Mount: 1.68 x 0.67 (H x W) 4. Hanging Mount: 1.9 x 0.67 in. (H x W) 5. Premium Diffusion: 1.52 x 0.67 in. (H x W)
45° Deco Channel DI-CPCHB-45DCO (45DCO) 48", 96" Aluminum, White, Black For 10mm Tape Light or Smaller	Height (H): 0.73 in. Width (W): 0.73 in. Interior Depth (ID): 0.42 in. Interior Width (IW): 0.47 in.	48 in. channel & frosted cover Mounting hardware End caps: 1x open, 1x closed. 96 in. channel & frosted cover Mounting hardware End caps: 2x open, 2x closed.	12mm Tape Light: Soldered Lead Only 	Classic Frosted Lens VLX1, VLX2, VLX3, VLX5, VLX8: Dotless	<ul style="list-style-type: none"> Beam Angle: 120° Classic Frosted Lens Light Loss: 20% CCT Shift: -40K IP Rating Shift: IP40 	 Mounting Clip: 0.73 x 0.73 in. (H x W)
90° Sideview Channel DI-CPCHB-90SD (90) 48", 96" Aluminum For 12mm Tape Light or Smaller	Height (H): 0.92 in. Width (W): 0.92 in. Interior Depth (ID): 0.3 in. Interior Width (IW): 0.49 in. Mounting Canal Width (MC): 0.25in	48 in. channel & frosted cover Mounting hardware End caps: 1x open, 1x closed. 96 in. channel & frosted cover Mounting hardware End caps: 2x open, 2x closed	12mm Tape Light: Soldered Lead Only 	Classic Frosted Lens VLX1, VLX2, VLX3, VLX5, VLX8: Dotless	<ul style="list-style-type: none"> Beam Angle: 120° Classic Frosted Lens Light Loss: 20% CCT Shift: -40K IP Rating Shift: IP40 	 Mounting Clip: 0.92 x 0.92 in. (H x W)



VALENT® X HIGH-DENSITY LED TAPE LIGHT

Specification Sheet

Date _____

Project Name _____

VALENT® X HIGH-DENSITY LED TAPE LIGHT

Precision-engineered, high density tape light for demanding applications.
Up to 900+ lumens per foot with 95+ CRI / 90+ R9. 12 year warranty.



24V VALENT® X RECOMMENDED CHANNELS

MODEL	DIAGRAM	INCLUDED ACCESSORIES	CONNECTION OPTIONS	IN CHANNEL DIFFUSION	TECHNICAL RATINGS	MOUNTING OPTIONS WITH DIMENSIONS
Reflector Channel DI-CPCHB-S1 (S1) 48", 96" Aluminum For 12mm Tape Light or Smaller	Height (H): 2.75 in. Width (W): 1 in. Interior Depth (ID): 0.29 in. Interior Width (IW): 0.54 in. Cut Out Width (CO): 2.35 in. Recessed Wing (RW): 0.2 in.	48 in. channel & frosted cover End caps: 1x open, 1x closed. 96 in. channel & frosted cover End caps: 1x open, 1x closed.	12mm Tape Light: Soldered Lead Only	Classic Frosted Lens VLX1, VLX2, VLX3, VLX5, VLX8: Dotless	<ul style="list-style-type: none"> Beam Angle: 120° Classic Frosted Lens Light Loss: 20% CCT Shift: -40K IP Rating Shift: IP40 	<p>Recessed Mount: 2.75 x 1 in. (H x W)</p>
Rod Channel DI-CPCHB-RDCL (ROD) 48", 96" Aluminum For 12mm Tape Light or Smaller	Height (H): 0.95 in. Width (W): 0.95 in. Interior Width (IW): 0.48 in. Height W/o Cover (H/C): 0.72 in.	78.74 in. channel & frosted lens 1x open end-cap, 1x closed end-cap 4x 180° swivel brackets 2x Closet Mounting Brackets 2x Support Brackets	12mm Tape Light: Soldered Lead Only	Classic Frosted Lens VLX1, VLX2, VLX3, VLX5, VLX8: Dotless	<ul style="list-style-type: none"> Beam Angle: 180° Classic Frosted Lens Light Loss: 20% CCT Shift: -40K IP Rating Shift: IP40 	<ol style="list-style-type: none"> Rotating Mount: 1.69 x 0.95 in. (H x W) Closet Mount: 1.28 x 3.25 in. (H x W) Art Lighting Arm: 2.72 x 10.15 in. (H x W) Wall Arm: 4.5 x 2.15 in. (H x W)
1-inch Mud-In Channel DI-CPCHB-MUD1 (MI1) 48", 96" Aluminum For 14mm Tape Light or Smaller	Height (H): 0.54 in. Width (W): 2.42 in. Interior Width (IW): 0.81 in. Cut Out Width (CO): 1.19 in.	96 in. channel & opal lens 2x surface mounting clips End caps: 2x open, 2x closed.	12mm Terminal Block Compatible	Opal Lens VLX1, VLX2, VLX3, VLX5, VLX8: Dotless	<ul style="list-style-type: none"> Beam Angle: 120° Opal Lens Light Loss: 55% CCT Shift: -200K IP Rating Shift: IP40 	<p>Recessed Mount: 0.54 x 2.42 in. (H x W)</p>
2-inch Mud-In Channel DI-CPCHB-MUD2 (MI2) 48", 96" Aluminum For 14mm Tape Light or Smaller	Height (H): 0.8 in. Width (W): 3.86 in. Interior Width (IW): 1.84 in. Cut Out Width (CO): 1.97 in.	96 in. channel & opal lens 2x surface mounting clips End caps: 2x open, 2x closed.	12mm Terminal Block Compatible	Opal Lens VLX1, VLX2, VLX3, VLX5, VLX8: Dotless	<ul style="list-style-type: none"> Beam Angle: 120° Opal Lens Light Loss: 55% CCT Shift: -200K IP Rating Shift: IP40 	<p>Recessed Mount: 0.8 x 3.86 in. (H x W)</p>
Recessed Channel DI-CPCHB-REC (REC) 48", 96" Aluminum For 14mm Tape Light or Smaller	Height (H): 0.49 in. Width (W): 1.03 in. Interior Depth (ID): 0.42 in. Interior Width (IW): 0.59 in. Cut Out Width (CO): 0.74 in. Recessed Wing (RW): 0.15 in.	48 in. channel & frosted lens 2x surface mounted clips End caps: 1x open, 1x closed 96 in. channel & frosted lens 4x surface mounted clips End caps: 2x open, 2x closed.	12mm Terminal Block Compatible	Classic Frosted Lens VLX1, VLX2, VLX3, VLX5, VLX8: Dotless	<ul style="list-style-type: none"> Beam Angle: 120° Classic Frosted Lens Light Loss: 20% CCT Shift: -40K IP Rating Shift: IP40 	<ol style="list-style-type: none"> 3M Adhesive: 0.59 x 1.03 in. (H x W) Recessed Mount: 0.49 x 1.03 in. (H x W)
Waveform Channel DI-CPCHB-WF (WF) 48" Aluminum For 12mm Tape Light or Smaller	Height (H): 0.3 in. Width (W): 0.71 in. Interior Width (IW): 0.49 in. Height W/o Cover (H/C): 0.2 in.	48 in. channel & frosted lens 2x surface mounting clips End caps: 1x open, 1x closed.	12mm Tape Light: Soldered Lead Only	Classic Frosted Lens	<ul style="list-style-type: none"> Beam Angle: 120° Min. Bend Radius: 8 in. Classic Frosted Lens Light Loss: 20% CCT Shift: -40K IP Rating Shift: IP40 	<ol style="list-style-type: none"> 3M Adhesive: 0.4 x 0.71 in. (H x W) U-Clip: 0.31 x 0.72 in. (H x W)

VALENT® X HIGH-DENSITY LED TAPE LIGHT

Precision-engineered, high density tape light for demanding applications.
Up to 900+ lumens per foot with 95+ CRI / 90+ R9. 12 year warranty.

Date _____

Project Name _____

12
Year
Warranty

IP20

24
VDC

NEC
FOR ALL FIXTURES
CLOSET RATED

TITLE
24

MECHANICAL DIAGRAMS

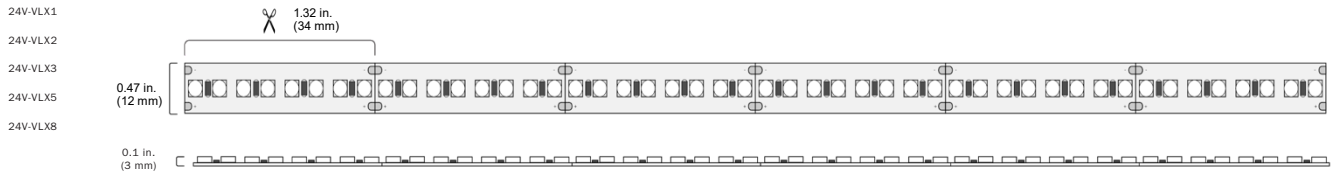

CONNECTIONS



ACCESSORIES

DI-TB12-CONN-TTW
12mm Tape-to-Wire Connector

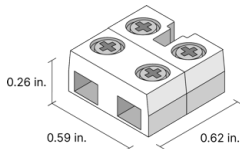

DI-TB12-CONN-TTT
12mm Tape-to-Wire Connector

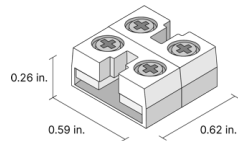

DI-TB12-90-TTT
12mm 90° Tape-to-Wire Connector

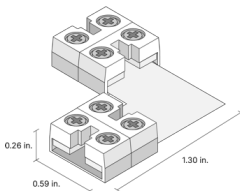

DI-TB12-60SPL-TTW
Splice Wire (Tape-to-Wire) (60 in.)

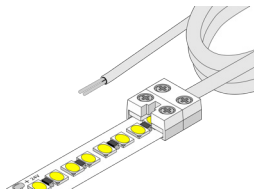

DI-TB12-6JPR-TTT
Jumper Cable (Tape-to-Tape) (6 in.)

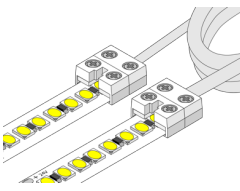

DI-TB12-60JPR-TTT
Jumper Cable (Tape-to-Tape) (60 in.)

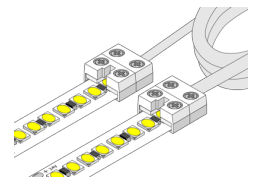

DELIVERY OPTIONS

- **Field Assembly**
Stock items for in-field assembly. Fastest order fulfillment.
- **Factory + Field (Hybrid)**
Finished lengths of light with leads. CHANNELS either bulk or factory finished. Some field assembly required.
- **Factory Assembly**
Fastest installation: fixtures fully assembled in the factory.

- Lumen value measured in accordance to IES LM-80-08. LED chips have a luminous flux range with a tolerance of +/- 5%.
- Each maximum run requires a dedicated power feed from the driver. Do not extend beyond the recommended maximum run length. Max run may exceed Class 2 limit. Actual wattage may differ from calculated wattage due to voltage drop across run.
- Do not install product in an environment outside the listed ambient temperature. Exceeding the maximum ambient temperature may damage LED chips, reduce the total lamp life, lumen output, and/or adversely impact color consistency.
- Actual efficacy value is dependent to specified LED driver (power supply). An estimated efficacy value can be calculated as follows: Lumen value divided by average power consumption per foot.
- Operating temperature is measured according to the minimum and maximum ambient temperature environment.



VALENT® X HIGH-DENSITY LED TAPE LIGHT

Specification Sheet

VALENT® X HIGH-DENSITY LED TAPE LIGHT

Precision-engineered, high density tape light for demanding applications.
Up to 900+ lumens per foot with 95+ CRI / 90+ R9. 12 year warranty.

Date _____

Project Name _____



RECOMMENDED 24V DRIVERS

SKU	INPUT VOLTAGE/ FREQUENCY	OUTPUT VOLTAGE	MAXIMUM LOAD	MINIMUM LOAD	CLASS 2	DIMMABLE	LENGTH	WIDTH	HEIGHT	
OMNIDRIVE® X Dimmable Driver Versatile driver for most high-performance dimming on ELV, TRIAC, and 0-10V Systems.					OMNIDRIVE® X Dimmable Driver Specification Sheet https://www.diodeled.com/custom/download/productFile/fileName/omnidrive-x-specification-sheet.pdf/					Contains: • Additional Models • Additional Features • Derating Curves • System Diagrams
DI-ODX-24V30W-J	120-277V	24V	30W	No minimum load	Yes	Yes	6.5 in.	3.7 in.	1.36 in.	
DI-ODX-24V60W-J	120-277V	24V	60W	No minimum load	Yes	Yes	7.4 in.	3.7 in.	1.36 in.	
DI-ODX-24V96W-J	120-277V	24V	96W	No minimum load	Yes	Yes	8.66 in.	3.7 in.	1.36 in.	
DI-ODX-24V120W-J	120-277V	24V	120W	No minimum load	No	Yes	8.66 in.	3.7 in.	1.36 in.	
OMNIDRIVE® X Electronic Dimmable Driver Our classic electronic dimmable (ELV) driver. Superior dimming and wide compatibility with popular dimmers.					OMNIDRIVE® X Electronic Dimmable Driver Specification Sheet https://www.diodeled.com/custom/download/productFile/fileName/omnidrive-indoor-electronic-dimmable-driver-specification-sheet.pdf/					Contains: • Additional Models • Additional Features • Derating Curves • System Diagrams
DI-TD-24V-45W-LPS3R	90-135VAC at 50/60Hz	24V	45W	Load at least 60% labeled load	Yes	Yes	10.79 in.	7.34 in.	2.36 in.	
DI-TD-24V-60W-LPS3R	90 - 135VAC 50/60Hz	24V	60W	Load at least 60% labeled load	Yes	Yes. Not compatible with PWM controls.	10.79 in.	7.34 in.	2.36 in.	
DI-TD-24V-80W-LPS3R	90 - 135VAC 50/60Hz	24V	80W	Load at least 60% labeled load	Yes	Yes. Not compatible with PWM controls.	10.79 in.	7.34 in.	2.36 in.	
VLM SERIES CONSTANT VOLTAGE DRIVER Compact driver for on/off, PWM dimming, and color-changing applications.					VLM Series Constant Voltage Driver Specification Sheet https://www.diodeled.com/custom/download/productFile/fileName/VLM-Specification%20Sheet%20(Driver%20&%20J-Box).pdf/					Contains: • Additional Models • Additional Features • Derating Curves • System Diagrams
VLM60W-24-LPS3R	120 / 277VAC 47 - 63Hz	24V	60W	No minimum load	Yes	PWM	10.79 in.	7.34 in.	2.36 in.	
VLM60W-24-LPM	120 / 277VAC 47 - 63Hz	24V	60W	No minimum load	Yes	PWM	10.79 in.	2.94 in.	1.31 in.	
POE (Power over Ethernet) Constant voltage platform, ready for Power over Ethernet (Inquire)										

RECOMMENDED CONTROLLERS

SKU	DESCRIPTION
CASAMBI® Controllers The CASAMBI controllers will remotely control your lighting through the app - downloadable for IOS & Android.	
CBU-PWM4	CASAMBI PWM4 Single Color Dimming Controller
CBU-A2D	CASAMBI A2D 2 Channel 0-10V/DALI Controller
CBU-ASR	CASAMBI ASR 0-10V Controller
CBU-TED	CASAMBI TED AC High Voltage Controller
SWITCHEX® Driver and Dimmer Switch LED driver and dimmer switch combined in a single gang box.	
DI-24V-SE-60W	SWITCHEX 24V Switch/Driver Combo - 60W
DI-24V-SE-100W	SWITCHEX 24V Switch/Driver Combo - 100W





VALENT® X HIGH-DENSITY LED TAPE LIGHT

Certifications and Warranty

VALENT® X HIGH-DENSITY LED TAPE LIGHT

Precision-engineered, high density tape light for demanding applications.
Up to 900+ lumens per foot with 95+ CRI / 90+ R9. 12 year warranty.

Date _____

Project Name _____



CERTIFICATIONS	WARRANTY
<p>SAFETY</p> <ul style="list-style-type: none"> UL Listed 2108 Low Voltage Lighting System / Low Voltage Luminaire. UL 1598 / CSA 250.0-08, UL 8750, UL 879 / CAN/CSA-C22.2 no. 207-M89. Certified for United States and Canada. File # E469769. UL Listed Field Cuttable. Approved for storage areas of clothes closets per NEC 410.16.A.3 and 410.16.C.5 CE & EMC Compliant: Verification No. GZEM141200683705V 	<p>LIMITED WARRANTY</p> <ul style="list-style-type: none"> 12 Year limited warranty <p>This warranty does not include the additional accessories referenced in this specification sheet. For warranty related questions please contact product support.</p>
<p>ENVIRONMENT</p> <ul style="list-style-type: none"> RoHS Compliant: Verification No. CANEC1610091501 	<p>CONSUMER'S ACKNOWLEDGMENT</p> <p>B+N Inc. stands behind its products when they are used properly and according to our specifications. By purchasing our products, the purchaser agrees and acknowledges that lighting design, configuration and installation is a complex process, wherein seemingly minor factors or changes in layout and in-field adjustments can have a significant impact on an entire system. Choosing the correct components is essential. B+N Inc. is able to work with the original purchaser to make an appropriate product selection to the extent of the limited information that the customer can provide, but it is virtually impossible for B+N Inc. to design a system that foresees every unknown factor. For this reason, this Warranty does not cover problems caused by improper design, configuration or installation issues. Any statement from a B+N Inc. employee or agent regarding a customer's bill of goods and/or purchase order is NOT an acknowledgment that the products purchased are designed and configured correctly. The purchase agrees and acknowledges that it is the customer's responsibility to adhere strictly to all information contained in the Product Specification Sheets.</p>
<p>PERFORMANCE</p> <ul style="list-style-type: none"> Can be used to comply with TITLE 24 Part 6 High Efficacy Lighting LED requirements - JAS-2016-2022-E LED chip data measured in accordance to IES LM-80-08. Photometric & Colorimetry data measured in accordance to IES LM-79-08, in Elemental LED's Innovation Lab. 	<p>There is often more than one way to design, configure and layout an LED lighting application properly to achieve the same lighting effect. B+N Inc. strongly recommends that licensed professionals be used in the design and installation of lighting systems that include B+N Inc. products. The specifications include important information that a designer and installer should carefully review and strictly follow. Qualified designers and certified and/or licensed installers, with access to the final installation environment, customer goals, and B+N Inc. product specifications can make the requisite decisions appropriate for a successful finished lighting application.</p>
<p>SAFETY / WARNINGS / DISCLOSURES</p> <ol style="list-style-type: none"> Install in accordance with national and local electrical code regulations. This product is intended to be installed and serviced by a qualified, licensed electrician. Only use copper wiring. Use wires rated for at least 176°F (80°C) and certified for use with external connection of electrical equipment. Each maximum run requires a dedicated power feed from the driver. Do not extend beyond the recommended maximum run length. Tape light, attached wire leads, and additional extension cables, connectors, etc., are not rated for in-wall installation unless otherwise noted. Tape light and attached wire leads are field-cuttable. Ensure applicable wire is installed between driver, fixture, and any controls in-between. When choosing wire, factor in voltage drop, amperage rating, and type (in-wall rated, wet location rated, etc.). Inadequate wire installation could overheat wires, and cause fire. Do not install in environment where LED chips are exposed to direct sunlight as damage to the phosphor will occur. Do not install in environment where excessive heat may exist (ex. close proximity to fireplace, etc.) See Ambient Temperature ratings. Do not install indoor LED tape light products in outdoor / wet location environments. Only wet location tape light models are rated for outdoor / wet locations. Do not modify product beyond instructions or warranty will be void. Tape light must be handled with care. Excessive handling, bending, and pressure may damage the product, voiding the warranty. Actual color may vary from what is pictured on this sheet and other print materials due to the limitations of photographic processes. We reserve the right to modify and improve the design of our fixtures without prior notice. We cannot guarantee to match existing installed fixtures for subsequent orders or replacements in regards to product appearance, CCT, or lumen output. 	

VALENT® X | WET LOCATION
HIGH-DENSITY LED TAPE LIGHT



VALENT® | WET LOCATION HIGH-DENSITY LED TAPE LIGHT

Precision-engineered, high-density tape light for demanding applications when light quality matters most. Up to 500+ lumens per foot with 95+ CRI/90+ R9. Suitable for wet locations (IP65).



24 VDC	95+ CRI	TITLE 24	 IP65
------------------	-------------------	---------------------------	---

FEATURES & BENEFITS

- Dense LED placement for uninterrupted linear light
- 95+ CRI/90+ R9
- Highest lumen output option

QUICK SPECS

VOLTAGE	24VDC
WIDTH	14mm
CRI	95+
WARRANTY	12 Year Limited Warranty
DIMMING	Dimmable
ENVIRONMENT	Outdoor/Wet Location (IP65)
CERTIFICATION	UL Listed 2108

DI	VOLTAGE	MODEL	CCT	LENGTH
DI	24V (24VDC)	VLX5	24 (2400K)	W016 (16.4 ft.)
			27 (2700K)	W100 (100 ft.)
			30 (3000K)	
			35 (3500K)	
			40 (4000K)	

EXAMPLE: 24V VALENT® X WET LOCATION 500 LUMENS 2700K 16.4 FT. SPOOL = **DI-24V-VLX5-27-W016**

24VDC	
500 LUMEN RANGE	
VLX5	
Max. Run: 30 ft.	Cut Points: 1.32 in. Wattage: 4.6W/ft.
CCT	Lumens/ft.
2400K	466
2700K	437
3000K	469
3500K	492
4000k	480



VALENT® X | WET LOCATION HIGH-DENSITY LED TAPE LIGHT

Specification Sheet

VALENT® X | WET LOCATION HIGH-DENSITY LED TAPE LIGHT

Versatile driver for most high-performance dimming on ELV, TRIAC, and 0-10V systems. Dims to dark depending on installation

Date _____

Project Name _____

12
Year
Warranty

IP65

24
VDC

NEC
410(A) & 410(C)(1)
CLOSET RATED

TITLE
24

FEATURES

- 500 Lumen output
- 95+ CRI
- 1.32 inch cuttable increments
- Precision color rendering with 90+ R9 value
- Ultra high lumen output
- 12 Year limited warranty



ORDERING CODES

Order spoils, and components for field assembly

OPTIONAL ORDERING CODES

Add Length, Assembly Preferences, and Finish

	VOLTAGE	MODEL	CCT	LENGTH	CHANNELS	FINISH	LENS	MOUNTING	DRIVER	DELIVERY			
DI													
	24V (24V Volt)	VLX5	27 (2700K)	W016 (16.4 feet)	A1 (A1)	RC20 (20mm Round)	45 (45°)	AL (Aluminum)	*blank* (Classic Frosted Lens)	3M (3M Adhesive)	ELV (Electronic)	O10 (0-10V)	Field Assembly
			30 (3000K)	W100 (100 feet)	S2 (S2)	SQ20 (20mm Square)	REC (Recessed)	BL (Black)	BL (Black Lens)	MC (Mounting Clip)	O/O (On/Off)	PoE (Power Over Ethernet)	Factory + Field (Hybrid)
			35 (3500K)		S45 (S45)	SL (Slim)	M11 (1-inch Mud-In)	WH (White)	CLT (Arch. Clear Lens)	UC (U-Clip)	LUT (Lutron)		Factory Assembly
			40 (4000K)		16 (16mm square)	SQ (Square)	M12 (2-inch Mud-In)		FRT (Arch. Frosted Lens)	UV (Vertical Clip)			
									OPT (Opal Lens)	HNG (Hanging Hardware)			
									PD (Pem. Diffusion Lens)	RC (Rotating Clip)			

* See Other page for Channel / Lens / Mounting Compatibility

VALENT® X WET LOCATION SPECIFICATION TABLE

MODEL	24V-VLX5
VOLTAGE	24VDC
WATTAGE	4.6W/ft.
2400k	466 Lm/ft.
2700k	437 Lm/ft.
Lumens 3000k	469 Lm/ft.
3500k	492 Lm/ft.
4000k	480 Lm/ft.
Cut Points	1.32 in.
Max Run (ft.)	30 ft.
CRI	95+
Dimensions	0.55 x 0.22 in. (W x H)
TM-21 (LM-80)	>50,000 hours
Environment	Outdoor / Wet Location (IP65)
Lead Wire A	36 in. Bare Lead 20/2 AWG UL 2464 Wire with Strain Relief
Lead Wire B	36 in. Bare Lead 20/2 AWG UL 2464 Wire with Strain Relief
LED Chips	72/ft.
Chip Type	2835
Certification	UL Listed 2108
Warranty	12 year





VALENT® X | WET LOCATION HIGH-DENSITY LED TAPE LIGHT

Specification Sheet

VALENT® X | WET LOCATION HIGH-DENSITY LED TAPE LIGHT

Versatile driver for most high-performance dimming on ELV, TRIAC, and 0-10V systems. Dims to dark depending on installation

Date _____

Project Name _____



CHANNEL / LENS / MOUNTING COMPATIBILITY

CHANNEL	COMPATIBLE LENSES	AVAILABLE FINISHES	MOUNTING OPTIONS
A1 (A1)	FRT	AL / WH / BL	UC
S2 (S2)	*Blank*	AL	UC
S45 (S45)	*Blank*	AL	UC
16 (16mm Square)	FRT	AL	MC
RC20 (20mm Round)	*Blank*	AL	UC
SQ20 (20mm Square)	*Blank*	AL	UC
SL (Slim)	*Blank* / CLT / FRT / BL / PD	AL / WH / BL	MC / 3M / MAG
SQ (Square)	*Blank* / CLT / FRT / BL / PD	AL / WH / BL	MC / VC / RC / HNG
45 (45°)	*Blank* / CLT / FRT / BL / PD	AL / WH / BL	MC / VC / RC / HNG
REC (Recessed)	*Blank*	AL	3M
M11 (1-inch Mud-In)	OPT	AL	
M12 (2-inch Mud-In)	OPT	AL	

LEGEND

LENS		FINISH		MOUNTING	
Blank	Classic Frosted Lens	AL	Aluminum	3M	3M Adhesive
BL	Black Lens	WH	White	HNG	Hanging Hardware
CLT	Architectural Clear Lens	BL	Black	MAG	Magnetic Clip
FRT	Architectural Frosted Lens			MC	Mounting Clip
OPT	Opal Lens			RC	Rotating Clip
PD	Premium Diffusion Lens			UC	U-Clip
				VC	Vertical Clip



VALENT® X | WET LOCATION HIGH-DENSITY LED TAPE LIGHT

Specification Sheet

VALENT® X | WET LOCATION HIGH-DENSITY LED TAPE LIGHT

Versatile driver for most high-performance dimming on ELV, TRIAC, and 0-10V systems. Dims to dark depending on installation

Date _____

Project Name _____

12
Year
Warranty

IP65

24
VDC

FOR A & B RANGES
CLOSET RATED

TITLE
24

24V VALENT® X WET LOCATION RECOMMENDED CHANNELS

MODEL	DIAGRAM	INCLUDED ACCESSORIES	CONNECTION OPTIONS	IN CHANNEL DIFFUSION	TECHNICAL RATINGS	MOUNTING OPTIONS WITH DIMENSIONS
A1 Channel Di-CHB-A1 (A1) 48", 96" Aluminum, White, Black <small>For 14mm Tape Light or Smaller</small>		48" Aluminum, Black, & White Channels <ul style="list-style-type: none"> 48 in. channel & lens 2x surface mounting clips 1 retaining clip End caps: 1x open, 1x closed. 90° Aluminum, Black, & White Channels <ul style="list-style-type: none"> 90 in. channel & lens 4x surface mounting clips 2x strain relief clip End caps: 2x open, 2x closed, 2x slotted 	14mm Tape Light: Soldered Lead Only	Architectural Frosted Lens VLX5: Dotless	<ul style="list-style-type: none"> Beam Angle: 120° Classic Frosted Lens Light Loss: 30% CCT Shift: -35K IP Rating Shift: IP40 	<p>U-Clip: 0.82 x 0.88 in. (H x W)</p>
S2 Channel Di-CHB-S2 (S2) 48", 96" Aluminum <small>For 14mm Tape Light or Smaller</small>		48 in. Channel & Frosted Lens, 1 open end cap, 1 closed end cap, 2 mounting clips, 2 mounting screws 96 in. Channel & Frosted Lens, 2 open end cap, 2 closed end cap, 4 mounting clips, 4 mounting screws	14mm Tape Light: Soldered Lead Only	Classic Frosted Lens VLX5: Dotless	<ul style="list-style-type: none"> Beam Angle: 120° Classic Frosted Lens Light Loss: 20% CCT Shift: -40K IP Rating Shift: IP40 	<p>U-Clip: 0.58 x 0.75 in. (H x W)</p>
S45 Channel Di-CHB-S45 (S45) 48", 96" Aluminum <small>For 14mm Tape Light or Smaller</small>		48 in. Channel & Frosted Lens, 1 open end cap, 1 closed end cap, 2 mounting clips, 2 mounting screws 96 in. Channel & Frosted Lens, 2 open end cap, 2 closed end cap, 4 mounting clips, 4 mounting screws	14mm Tape Light: Soldered Lead Only	Classic Frosted Lens VLX5: Dotless	<ul style="list-style-type: none"> Beam Angle: 120° Classic Frosted Lens Light Loss: 20% CCT Shift: -40K IP Rating Shift: IP40 	<p>U-Clip: 0.79 x 0.79 in. (H x W)</p>
Slim Channel Di-CPCHB-SL (SL) 48", 96" Aluminum, White, Black <small>For 14mm Tape Light or Smaller</small>		48" Aluminum, Black, & White Channels <ul style="list-style-type: none"> 48 in. channel & lens 2x surface mounting clips End caps: 1x open, 1x closed 96" Aluminum, Black, & White Channels <ul style="list-style-type: none"> 96 in. channel & lens 4x surface mounting clips End caps: 2x open, 2x closed 	14mm Tape Light: Soldered Lead Only	Architectural Frosted Lens VLX5: Semi-Diffused Premium Diffusion Lens VLX5: Dotless For diffusion options not listed, refer to Slim Channel Specification Sheet.	<ul style="list-style-type: none"> Beam Angle: 120° Architectural Clear Lens Light Loss: 10% CCT Shift: -20K Architectural Frosted Lens Light Loss: 30% CCT Shift: -35K Classic Frosted Lens Light Loss: 20% CCT Shift: -40K Black Lens Light Loss: 90% CCT Shift: -350K Premium Diffusion Lens Light Loss: 10% CCT Shift: -30K IP Rating Shift: IP40 	<ol style="list-style-type: none"> 1. Slim Mount: 0.54 x 0.87 in. (H x W) 2. 3M Adhesive: 0.48 x 0.82 in. (H x W) 3. Magnetic U-Clip: 0.59 x 0.82 in. (H x W) 4. Premium Diffusion: 0.96 x 0.82 in. (H x W)
16mm Square Channel Di-CPCHB-16MM (16) 48", 96" Aluminum <small>For 14mm Tape Light or Smaller</small>		48 in. channel & Architectural Frosted Lens <ul style="list-style-type: none"> 2x surface mounting clips End caps: 1x open, 1x closed. 96 in. channel & Architectural Frosted Lens <ul style="list-style-type: none"> 4x surface mounting clips End caps: 2x open, 2x closed. 	14mm Tape Light: Soldered Lead Only	Architectural Frosted Lens VLX5: Dotless	<ul style="list-style-type: none"> Beam Angle: 120° Architectural Frosted Lens Light Loss: 30% CCT Shift: -35K Black Lens Light Loss: 90% CCT Shift: -350K IP Rating Shift: IP40 	<p>Mounting Clip: 0.89 x 0.77 in. (H x W)</p>
20mm Round Channel Di-CPCHB-RC20 (RC20) 48", 96" Aluminum <small>For 14mm Tape Light or Smaller</small>		48 in. channel & frosted lens 2x surface mounting clips End caps: 1x open, 1x closed. 96 in. channel & frosted lens 4x surface mounting clips End caps: 2x open, 2x closed.	14mm Tape Light: Soldered Lead Only	Classic Frosted Lens VLX5: Dotless	<ul style="list-style-type: none"> Beam Angle: 180° Classic Frosted Lens Light Loss: 20% CCT Shift: -40K IP Rating Shift: IP40 	<p>U-Clip: 1.19 x 1.19 in. (H x W)</p>



VALENT® X | WET LOCATION HIGH-DENSITY LED TAPE LIGHT

Specification Sheet

VALENT® X | WET LOCATION HIGH-DENSITY LED TAPE LIGHT

Versatile driver for most high-performance dimming on ELV, TRIAC, and 0-10V systems. Dims to dark depending on installation

Date _____

Project Name _____

12
Year
Warranty

IP65

24
VDC

FOR RATED ENCLOSURES
CLOSET RATED

TITLE
24

24V VALENT® X WET LOCATION RECOMMENDED CHANNELS

MODEL	DIAGRAM	INCLUDED ACCESSORIES	CONNECTION OPTIONS	IN CHANNEL DIFFUSION	TECHNICAL RATINGS	MOUNTING OPTIONS WITH DIMENSIONS
20mm Square Channel DI-CPCHB-SQC20 (SQ20) 48", 96" Aluminum <small>For 14mm Tape Light or Smaller</small>	Height (H): 1.18 in. Width (W): 1.18 in. Interior Depth (ID): 0.84 in. Interior Width (IW): 0.84 in. 	48 in. channel & frosted lens • 2x surface mounting clips • End caps: 1x open, 1x closed. 96 in. channel & frosted lens • 4x surface mounting clips • End caps: 2x open, 2x closed.	14mm Tape Light: Soldered Lead Only	Classic Frosted Lens VLX5: Dotless	<ul style="list-style-type: none"> Beam Angle: 180° Classic Frosted Lens Light Loss: 20% CCT Shift: -40K IP Rating Shift: IP40 	<p>U-Clip: 1.19 x 1.19 in. (H x W)</p>
Square Channel DI-CPCHB-SQ (SQ) 48", 96" Aluminum, White, Black <small>For 14mm Tape Light or Smaller</small>	Height (H): 0.55 in. Width (W): 0.82 in. Interior Depth (ID): 0.27 in. Interior Width (IW): 0.67 in. 	48" Aluminum Channel • 48 in. channel & frosted lens • 2x surface mounting clips • End caps: 1x open, 1x closed. 48" Black & White Channels • 48 in. channel & clear, or frosted lens • 4x surface mounted clips • 2x End-to-end interconnects 96" Aluminum Channel • 96 in. channel & frosted lens • 4x surface mounting clips • End caps: 2x open, 2x closed. 96" Black & White Channels • 96 in. channel & clear, or frosted lens • 4x surface mounted clips • 2x End-to-end interconnects	14mm Tape Light: Soldered Lead Only	Architectural Frosted Lens VLX5: Semi-Diffused Premium Diffusion Lens VLX5: Dotless For diffusion options not listed, refer to Square Channel Specification Sheet.	<ul style="list-style-type: none"> Beam Angle: 120° Architectural Clear Lens Light Loss: 10% CCT Shift: -20K Architectural Frosted Lens Light Loss: 30% CCT Shift: -35K Classic Frosted Lens Light Loss: 20% CCT Shift: -40K Black Lens Light Loss: 90% CCT Shift: -350K Premium Diffusion Lens Light Loss: 10% CCT Shift: -30K IP Rating Shift: IP40 	<ol style="list-style-type: none"> Chromapath Surface Mount: 0.61 x 0.82 in. (H x W) Vertical Mount: 0.61 x 0.82 in. (H x W) Rotating Mount: 1.29 x 0.82 (H x W) Hanging Mount: 1.51 x 0.82 in. (H x W) Premium Diffusion: 1.13 x 0.82 in. (H x w)
45° Channel DI-CPCHB-45 (45) 48", 96" Aluminum, White, Black <small>For 14mm Tape Light or Smaller</small>	Height (H): 0.94 in. Width (W): 0.67 in. Interior Depth (ID): 0.32 in. Interior Width (IW): 0.67 in. 	48" Aluminum, Black, & White Channels • 48 in. channel & clear, or frosted lens • 4x surface mounted clips • 2x End-to-end interconnects 96" Aluminum Channel • 96 in. channel & clear, or frosted lens • 8x surface mounted clips • 4x End-to-end interconnects 96" Black & White Channels • 96 in. channel & clear, or frosted lens • 4x surface mounted clips • 2x End-to-end interconnects	14mm Tape Light: Soldered Lead Only	Architectural Frosted Lens VLX5: Semi-Diffused Premium Diffusion Lens VLX5: Dotless For diffusion options not listed, refer to 45° Channel Specification Sheet.	<ul style="list-style-type: none"> Beam Angle: 120° Architectural Clear Lens Light Loss: 10% CCT Shift: -20K Architectural Frosted Lens Light Loss: 30% CCT Shift: -35K Classic Frosted Lens Light Loss: 20% CCT Shift: -40K Black Lens Light Loss: 90% CCT Shift: -350K Premium Diffusion Lens Light Loss: 10% CCT Shift: -30K IP Rating Shift: IP40 	<ol style="list-style-type: none"> Chromapath Surface Mount: 1 x 0.67 in. (H x W) Vertical Mount: 1 x 0.67 in. (H x W) Rotating Mount: 1.68 x 0.67 (H x W) Hanging Mount: 1.9 x 0.67 in. (H x W) Premium Diffusion: 1.52 x 0.67 in. (H x w)
Recessed Channel DI-CPCHB-REC (REC) 48", 96" Aluminum <small>For 14mm Tape Light or Smaller</small>	Height (H): 0.49 in. Width (W): 1.03 in. Interior Depth (ID): 0.42 in. Interior Width (IW): 0.59 in. Cut Out Width (CO): 0.74 in. Recessed Wing (RW): 0.15 in. 	48 in. channel & frosted lens • 2x surface mounted clips • End caps: 1x open, 1x closed 96 in. channel & frosted lens • 4x surface mounted clips • End caps: 2x open, 2x closed.	14mm Tape Light: Soldered Lead Only	Classic Frosted Lens VLX5: Dotless	<ul style="list-style-type: none"> Beam Angle: 120° Classic Frosted Lens Light Loss: 20% CCT Shift: -40K IP Rating Shift: IP40 	<ol style="list-style-type: none"> 3M Adhesive: 0.59 x 1.03 in. (H x W) Recessed Mount: 0.49 x 1.03 in. (H x W)
1-inch Mud-In Channel DI-CPCHB-MUD1 (MI1) 48", 96" Aluminum <small>For 14mm Tape Light or Smaller</small>	Height (H): 0.54 in. Width (W): 2.42 in. Interior Width (IW): 0.81 in. Cut Out Width (CO): 1.19 in. 	96 in. channel & opal lens 2x surface mounting clips End caps: 2x open, 2x closed.	14mm Tape Light: Soldered Lead Only	Opal Lens VLX5: Dotless	<ul style="list-style-type: none"> Beam Angle: 120° Opal Lens Light Loss: 55% CCT Shift: -200K IP Rating Shift: IP40 	<p>Recessed Mount: 0.54 x 2.42 in. (H x W)</p>
2-inch Mud-In Channel DI-CPCHB-MUD2 (MI2) 48", 96" Aluminum <small>For 14mm Tape Light or Smaller</small>	Height (H): 0.8 in. Width (W): 3.86 in. Interior Width (IW): 1.84 in. Cut Out Width (CO): 1.97 in. 	96 in. channel & opal lens • 2x surface mounting clips • End caps: 2x open, 2x closed.	14mm Tape Light: Soldered Lead Only	Opal Lens VLX5: Dotless	<ul style="list-style-type: none"> Beam Angle: 120° Opal Lens Light Loss: 55% CCT Shift: -200K IP Rating Shift: IP40 	<p>Recessed Mount: 0.8 x 3.86 in. (H x W)</p>



VALENT® X WET LOCATION HIGH-DENSITY LED TAPE LIGHT

Mechanical Diagrams, Accessories, & Delivery Options

Date _____

Project Name _____

VALENT® X WET LOCATION HIGH-DENSITY LED TAPE LIGHT

Versatile driver for most high-performance dimming on ELV, TRIAC, and 0-10V systems. Dims to dark depending on installation

12
Year
Warranty

IP65

24
VDC

NEC
DORMA & HORNBECK
CLOSET RATED

TITLE
24

MECHANICAL DIAGRAMS

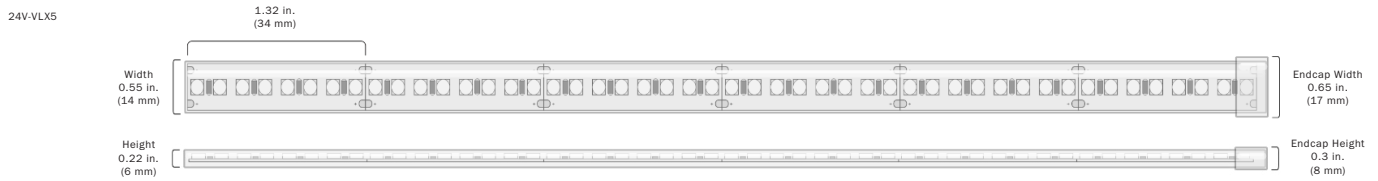

CONNECTIONS



ACCESSORIES

Soldered Lead Only

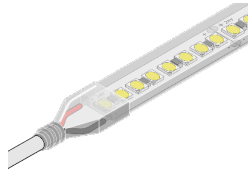

DI-WLMC-12MM
12mm Tape, Wet Location Over Clips, 10 pack, with 20 screws

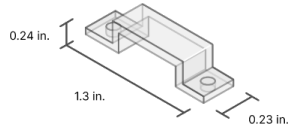

DI-WL-12MM-EC-5
Wet Location Strip End Caps, 12mm Tape, Silicone, 5-pack (5 open, 5 closed)

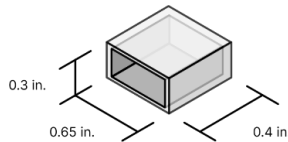

DI-WPSL
Wet Location Sealant

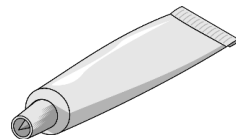

DELIVERY OPTIONS

- **Field Assembly**
Fastest order fulfillment. Field connectors and accessories not included.
- **Factory + Field (Hybrid)**
Onsite modifications with factory connection. Additional Accessories not included.
- **Factory Assembly**
Fastest installation. Factory made-to-order fixtures.

- Lumen value measured in accordance to IES LM-80-08. LED chips have a luminous flux range with a tolerance of +/- 5%.
- Each maximum run requires a dedicated power feed from the driver. Do not extend beyond the recommended maximum run length. Max run may exceed Class 2 limit. Actual wattage may differ from calculated wattage due to voltage drop across run.
- Do not install product in an environment outside the listed ambient temperature. Exceeding the maximum ambient temperature may damage LED chips, reduce the total lamp life, lumen output, and/or adversely impact color consistency.
- Actual efficacy value is dependent to specified LED driver (power supply). An estimated efficacy value can be calculated as follows: Lumen value divided by average power consumption per foot.
- Operating temperature is measured according to the minimum and maximum ambient temperature environment.



VALENT® X | WET LOCATION HIGH-DENSITY LED TAPE LIGHT

Specification Sheet

VALENT® X | WET LOCATION HIGH-DENSITY LED TAPE LIGHT

Versatile driver for most high-performance dimming on ELV, TRIAC, and 0-10V systems. Dims to dark depending on installation

Date _____

Project Name _____

12
Year
Warranty

IP65

24
VDC

FOR A & B RATED CLOSET RATED

TITLE
24

RECOMMENDED 24V DRIVERS

SKU	INPUT VOLTAGE/ FREQUENCY	OUTPUT VOLTAGE	MAXIMUM LOAD	MINIMUM LOAD	CLASS 2	DIMMABLE	LENGTH	WIDTH	HEIGHT	
OMNIDRIVE® X Dimmable Driver Versatile driver for most high-performance dimming on ELV, TRIAC, and 0-10V Systems.					OMNIDRIVE® X Dimmable Driver Specification Sheet https://www.diodeled.com/custom/download/productFile/fileName/omnidrive-x-specification-sheet.pdf/				Contains: • Additional Models • Additional Features • Derating Curves • System Diagrams	
DI-ODX-24V30W-J	120-277V	24V	30W	No minimum load	Yes	Yes	6.5 in.	3.7 in.	1.57 in.	
DI-ODX-24V60W-J	120-277V	24V	60W	No minimum load	Yes	Yes	7.4 in.	3.7 in.	1.57 in.	
DI-ODX-24V96W-J	120-277V	24V	96W	No minimum load	Yes	Yes	8.66 in.	3.7 in.	1.57 in.	
DI-ODX-24V120W-J	120-277V	24V	120W	No minimum load	No	Yes	8.66 in.	3.7 in.	1.57 in.	
VLM SERIES CONSTANT VOLTAGE DRIVER Compact driver for on/off, PWM dimming, and color-changing applications					VLM Series Constant Voltage Driver Specification Sheet https://www.diodeled.com/custom/download/productFile/fileName/VLM-Specification%20Sheet%20(Driver%20%20J-Box).pdf/				Contains: • Additional Models • Additional Features • Derating Curves • System Diagrams	
VLM60W-24-LPS3R	120 / 277VAC 47 - 63Hz	24V	60W	No minimum load	Yes	PWM	10.79 in.	7.34 in.	2.36 in.	
VLM60W-24-LPM	120 / 277VAC 47 - 63Hz	24V	60W	No minimum load	Yes	PWM	8.19 in.	2.94 in.	1.31 in.	
VLM100W-24-LPS3R	120 / 277VAC 47 - 63Hz	24V	100W	No minimum load	Yes	PWM	10.79 in.	7.34 in.	2.36 in.	
MEANWELL CONSTANT VOLTAGE DRIVER Driver for on/off, or PWM dimming applications.					MEANWELL Constant Voltage Driver Specification Sheet https://www.diodeled.com/custom/download/productFile/fileName/commercial-grade-CV-Driver-Specification%20Sheet%20(24V%20Models).pdf/				Contains: • Additional Models • Additional Features • Derating Curves • System Diagrams	
DI-CV-MW24V60W-277-LPS3R	120 ~ 277VAC 50/60Hz	24V	60W	No minimum load	Yes	Yes, with compatible PWM dimmer/controls	10.79 in.	7.34 in.	2.36 in.	
DI-CV-MW24V60W-277-LPS	120 ~ 277VAC 50/60Hz	24V	60W	No minimum load	Yes	Yes, with compatible PWM dimmer/controls	11.25 in.	3.75 in.	1.9 in.	
POE (Power over Ethernet) Constant voltage platform, ready for Power over Ethernet (Inquire)										

RECOMMENDED CONTROLLERS

SKU	DESCRIPTION
CASAMBI® Controllers The CASAMBI controllers will remotely control your lighting through the app - downloadable for IOS & Android.	
CBU-PWM4	CASAMBI PWM4 Single Color Dimming Controller
CBU-A2D	CASAMBI A2D 2 Channel 0-10V/DALI Controller
CBU-ASR	CASAMBI ASR 0-10V Controller
CBU-TED	CASAMBI TED AC High Voltage Controller
SWITCHEX® Driver and Dimmer Switch LED driver and dimmer switch combined in a single gang box.	
DI-12V-SE-40W	SWITCHEX 12V Switch/Driver Combo - 40W
DI-12V-SE-60W	SWITCHEX 12V Switch/Driver Combo - 60W





VALENT® X | WET LOCATION HIGH-DENSITY LED TAPE LIGHT

Specification Sheet

VALENT® X | WET LOCATION HIGH-DENSITY LED TAPE LIGHT

Versatile driver for most high-performance dimming on ELV, TRIAC, and 0-10V systems. Dims to dark depending on installation

Date _____

Project Name _____



CERTIFICATIONS	WARRANTY
<p>SAFETY</p> <ul style="list-style-type: none"> UL Listed 2108 Low Voltage Lighting System / Low Voltage Luminaire. UL 1598 / CSA 250.0-08, UL 8750, UL 879 / CAN/CSA-C22.2 no. 207-MB9. Certified for United States and Canada. File # E469769. UL Listed Field Cuttable. Approved for storage areas of clothes closets per NEC 410.16.A.1,3 and 410.16.C.1,3,5 CE & EMC Compliant: Verification No. GZEM141200683705V 	<p>LIMITED WARRANTY</p> <ul style="list-style-type: none"> 12 Year limited warranty <p>This warranty does not include the additional accessories referenced in this specification sheet. Complete warranty details for fixtures and additional accessories are available at www.diodeled.com/limited-warranty/ within the Policies section. For warranty related questions please contact product support.</p>
<p>ENVIRONMENT</p> <ul style="list-style-type: none"> Ambient Temperature: -4 - 122°F (-20 - 50°C) Operating Temperature: -4 - 176°F (-20 - 80°C) RoHS Compliant: Verification No. CANEC1610091501 	<p>CONSUMER'S ACKNOWLEDGMENT</p> <p>Elemental LED, Inc. stands behind its products when they are used properly and according to our specifications. By purchasing our products, the purchaser agrees and acknowledges that lighting design, configuration and installation is a complex process, wherein seemingly minor factors or changes in layout and infield adjustments can have a significant impact on an entire system. Choosing the correct components is essential. Elemental LED is able to work with the original purchaser to make an appropriate product selection to the extent of the limited information that the customer can provide, but it is virtually impossible for Elemental LED to design a system that foresees every unknown factor. For this reason, this Warranty does not cover problems caused by improper design, configuration or installation issues. Any statement from a Elemental LED employee or agent regarding a customer's bill of goods and/or purchase order is NOT an acknowledgment that the products purchased are designed and configured correctly. The purchase agrees and acknowledges that it is the customer's responsibility to adhere strictly to all information contained in the Product Specification Sheets.</p>
<p>PERFORMANCE</p> <ul style="list-style-type: none"> Can be used to comply with TITLE 24 Part 6 High Efficacy Lighting LED requirements - JAB-2016-2022-E LED chip data measured in accordance to IES LM-80-08. Photometric & Colorimetry data measured in accordance to IES LM-79-08, in Elemental LED's Innovation Lab. 	<p>There is often more than one way to design, configure and layout an LED lighting application properly to achieve the same lighting effect. Elemental LED strongly recommends that licensed professionals be used in the design and installation of lighting systems that include Elemental LED products. The specifications include important information that a designer and installer should carefully review and strictly follow. Qualified designers and certified and/or licensed installers, with access to the final installation environment, customer goals, and Elemental LED product specifications can make the requisite decisions appropriate for a successful finished lighting application.</p>
<p>SAFETY / WARNINGS / DISCLOSURES</p> <ul style="list-style-type: none"> Install in accordance with national and local electrical code regulations. This product is intended to be installed and serviced by a qualified, licensed electrician. Only use copper wiring. Use wires rated for at least 176°F (80°C) and certified for use with external connection of electrical equipment. Each maximum run requires a dedicated power feed from the driver. Do not extend beyond the recommended maximum run length. Tape light, attached wire leads, and additional extension cables, connectors, etc., are not rated for in-wall installation unless otherwise noted. Tape light and attached wire leads are field-cuttable. Ensure applicable wire is installed between driver, fixture, and any controls in-between. When choosing wire, factor in voltage drop, amperage rating, and type (in-wall rated, wet location rated, etc.). Inadequate wire installation could overheat wires, and cause fire. Do not install in environment where LED chips are exposed to direct sunlight as damage to the phosphor will occur. Do not install in environment where excessive heat may exist (ex. close proximity to fireplace, etc.) See Ambient Temperature ratings Do not install indoor LED tape light products in outdoor / wet location environments. Only wet location tape light models are rated for outdoor / wet locations. Do not modify product beyond instructions or warranty will be void. Tape light must be handled with care. Excessive handling, bending, and pressure may damage the product, voiding the warranty. Actual color may vary from what is pictured on this sheet and other print materials due to the limitations of photographic processes. We reserve the right to modify and improve the design of our fixtures without prior notice. We cannot guarantee to match existing installed fixtures for subsequent orders or replacements in regards to product appearance, CCT, or lumen output. 	

DRIVERS



BN

OMNIDRIVE® X

DIMMABLE DRIVER

OMNIDRIVE® X is a driver with universal dimmer compatibility in most high-performance dimming applications. Simplify installation with universal input voltage and multiple dimming protocols in a single driver.



**24
VDC**

FEATURES & BENEFITS

- ELV, TRIAC, and 0-10V dimming in a single driver
- 100-277VAC universal input
- No minimum load
- Minimum dimming level of <1%, depending on the dimmer
- UL Listed and Title 24 compliant

QUICK SPECS

ENVIRONMENT	Indoor/Outdoor
INPUT VOLTAGE	100-277VAC
OUTPUT VOLTAGE	12VDC & 24VDC Models
CONNECTION TYPE	Hardwired
WARRANTY	5 Year Limited Warranty
DIMMING	Forward Phase, Reverse Phase Dimming, and 0-10V Dimming
CERTIFICATION	UL Listed & JA8/JA10 Compliant

24V OMNIDRIVE® X

OUTPUT	SKU	WATTAGE	CLASS 2	ENVIRONMENT	DIMENSIONS W/O J-BOX	DIMENSIONS W/ J-BOX (-J)
24 VDC	DI-ODX-24V30W(-J)*	30W	Yes	Indoor/Outdoor	2.1x0.8x6.1 in.	3.7x1.36x6.5 in.
	DI-ODX-24V60W(-J)*	60W	Yes	Indoor/Outdoor	2.4x1x7 in.	3.7x1.36x7.4 in.
	DI-ODX-24V96W(-J)*	96W	Yes	Indoor/Outdoor	2.7x1.7x9 in.	3.7x1.36x8.66 in.
	DI-ODX-24V120W-J	120W	No	Indoor/Outdoor	-	3.7x1.36x8.66 in.
	DI-ODX-24V200W-J	200W	No	Indoor/Outdoor	-	4.92x1.95x10.24 in.

12V OMNIDRIVE® X

OUTPUT	SKU	WATTAGE	CLASS 2	ENVIRONMENT	DIMENSIONS W/O J-BOX	DIMENSIONS W/ J-BOX (-J)
12 VDC	DI-ODX-12V30W(-J)*	30W	Yes	Indoor/Outdoor	2.1x0.8x6.1 in.	3.7x1.36x6.5 in.
	DI-ODX-12V60W(-J)*	60W	Yes	Indoor/Outdoor	2.4x1x7 in.	3.7x1.36x7.4 in.
	DI-ODX-12V100W-J	100W	No	Indoor/Outdoor	-	3.7x1.36x8.66 in.
	DI-ODX-12V120W-J	120W	No	Indoor/Outdoor	-	3.7x1.36x8.66 in.
	DI-ODX-12V200W-J	200W	No	Indoor/Outdoor	-	4.92x1.95x10.24 in.

These drivers have an optional junction box (J). For driver only, do not include "-J".

COMMERCIAL GRADE PLUG-IN ADAPTER

24VDC Plug-in Adapters convert 120VAC voltage to 24VDC output. An adapter is the right choice for portable installations where hard-wiring is not desired.



FEATURES & BENEFITS

- Black Finish
- Short circuit, over current, over voltage, over temperature protections
- Fanless design/cooling by free-air convection
- UL listed 1310 Class 2
- For use with commercial applications

QUICK SPECS

ENVIRONMENT	Indoor/Dry Locations
INPUT VOLTAGE	100-240VAC
OUTPUT VOLTAGE	24VDC
CONNECTION TYPE	Wire
WARRANTY	3 Year Limited Warranty
DIMMING	PWM
CERTIFICATION	UL Listed

Visit the product page on the website for specification sheets, install guides, IES files, and photometric reports.

DI	MODEL	VOLTAGE/WATTAGE	CLASS	COLOR	GRADE
DI	PA	24V96W	CL2	B (Black)	CG (Commercial Grade)

EXAMPLE: 24V 96W Commercial Grade Plug-In Adapter = **DI-PA-24V96W-CL2-B-CG**



B+N Industries

Main Offices:

**15 Guittard Road
Burlingame, California 94010
800.350.4127
www.BNind.com**

New York Showroom and Offices:

(By Appointment Only)

**420 West 14th Street
New York, New York 10014
212.255.4110**

Houston Showroom and Offices:

(By Appointment Only)

**1800 Bering Drive, Suite 500
Houston, Texas 77057
713.430.9100**

© B&N Industries, Inc.



facebook.com/BNIndustries
instagram.com/bn_industries/
linkedin.com/company/b&n-industries
pinterest.com/bnindustries/