

# MURO

# ASSEMBLY & INSTALLATION

## FLOOR TO CEILING

REV 2025.08.05

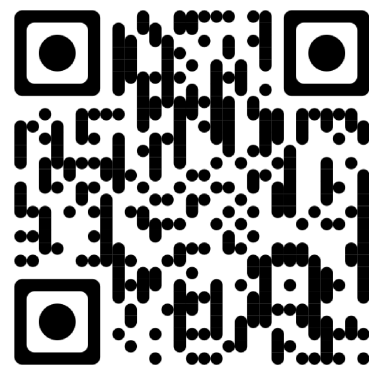

B+N Muro Website

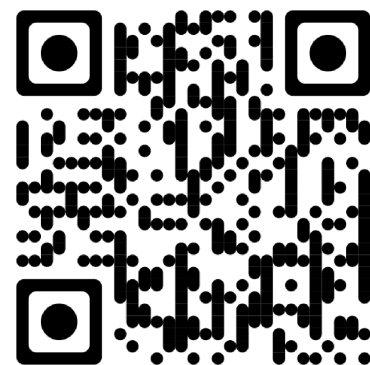

Muro Configurator

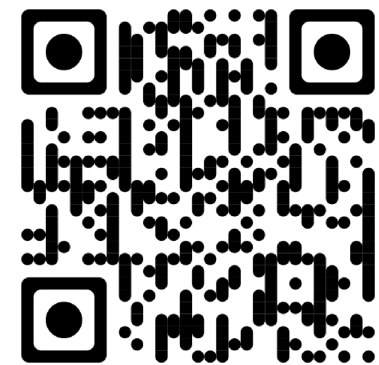

Muro Installation Guide

# MURO "FLOOR TO CEILING SETUP"

## SYSTEM OVERVIEW

**GENERAL SCOPE:** This document details a basic MURO Floor To Ceiling installation. It is necessary to familiarize yourself with System 1224 basics by reading "System 1224 Assembly and Installation Instructions" which covers many details not covered in this document.

**PROVIDED:**  
(2) 5/32 Allen keys

**NOT PROVIDED:**

- Appropriate hardware to attach feet to ceiling and floor.
- Cord management materials like double-stick tape, zip ties, velcro and other material.

**RECOMMENDED TOOLS:**

- Hand Drill + necessary drill and driver bits
- Large crescent wrench
- Levels
- Tape Measure

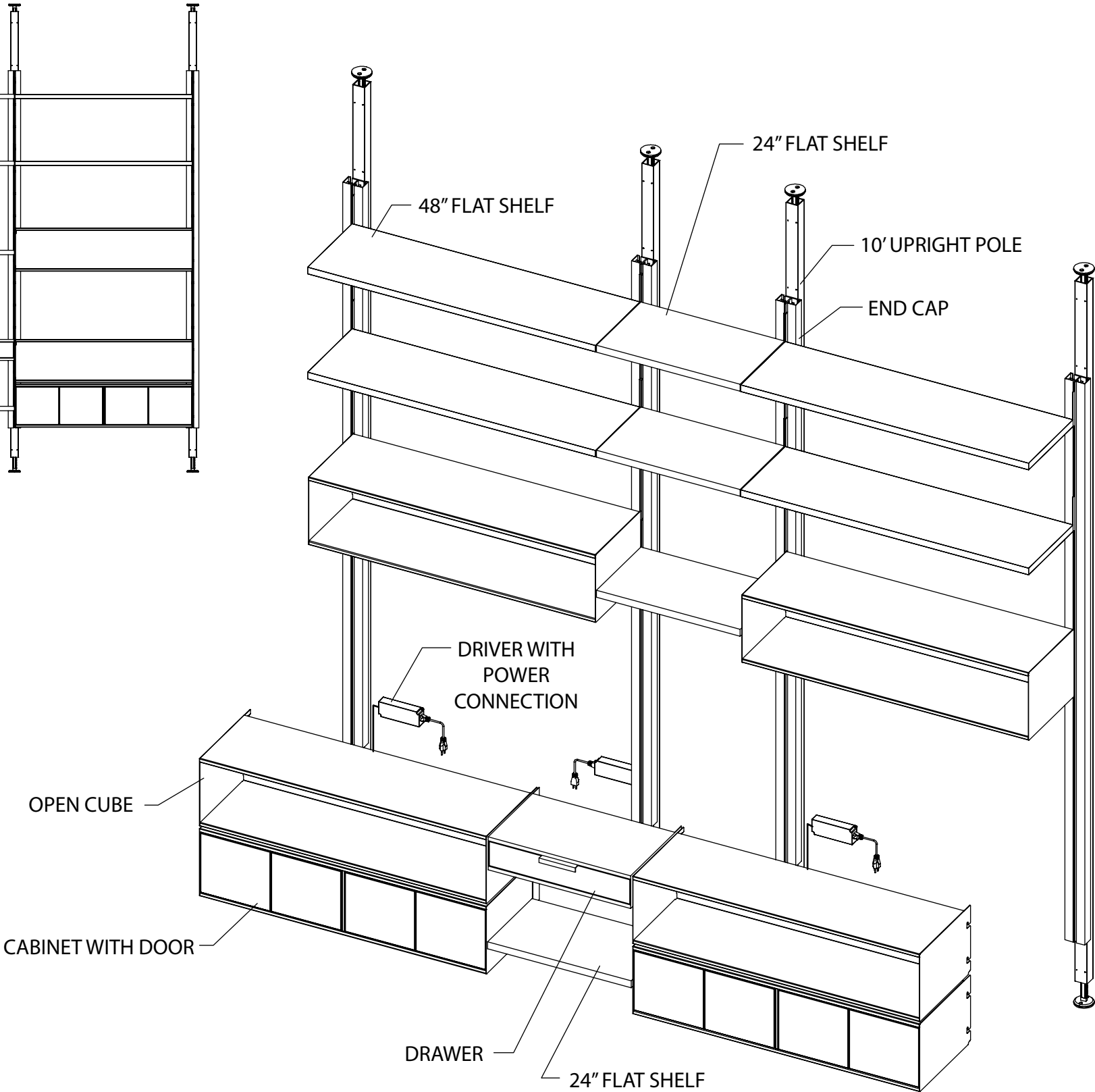

# MURO "FLOOR TO CEILING SETUP"

## INSTALLING 1ST UPRIGHT

PAGE  
2 of 7

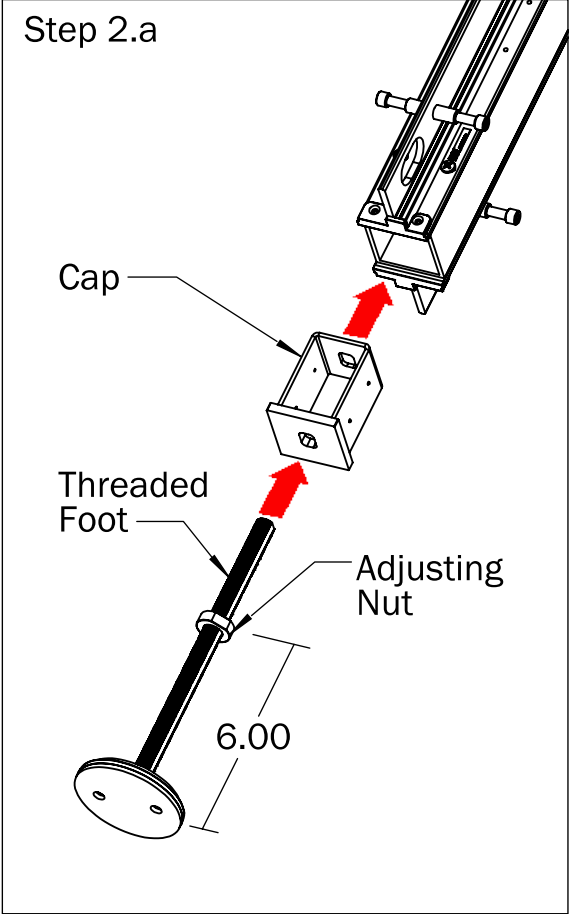
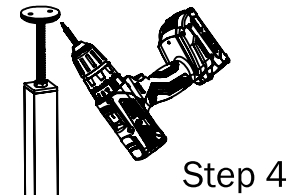
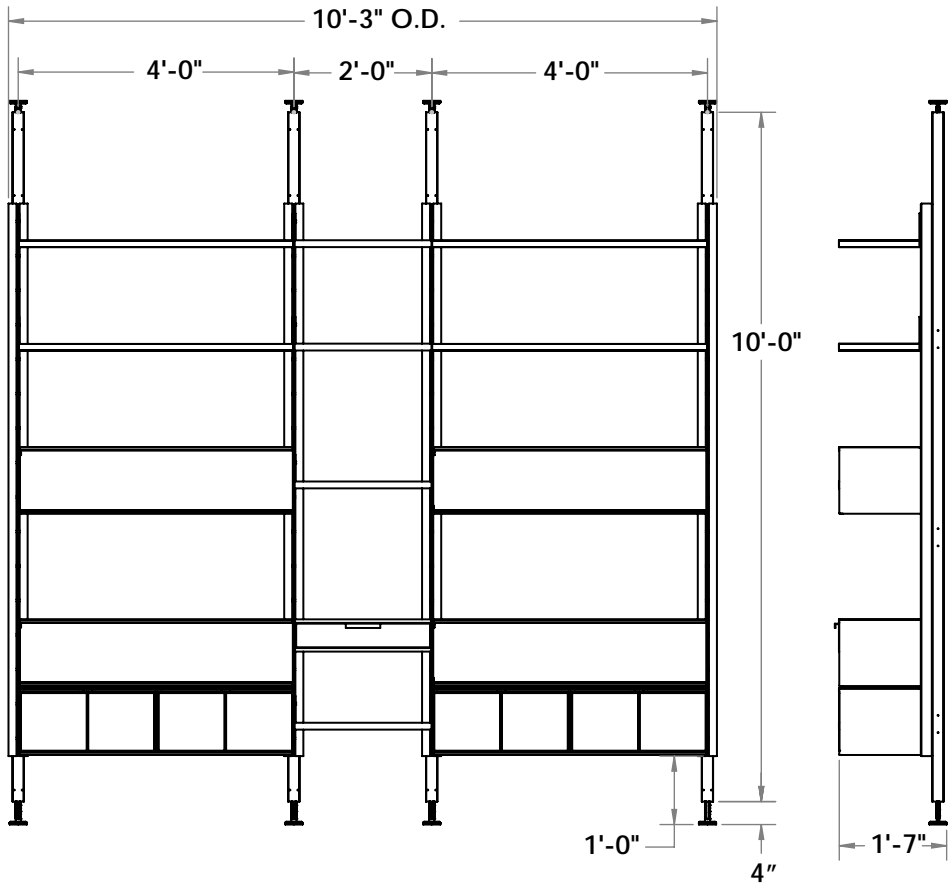

STEP 1: Based on drawings provided, plot out the location of the elevation, and determine the starting place of the first upright. Using tape or a chalk line, create a straight line on the floor for the elevation to follow. **Finally, blocking needed to be constructed in the ceiling for structure support.**

The G.C. is to insure that appropriate electrical outlets can be reached from the elevation at either the ceiling or floor.

The Floor To Ceiling poles are composed of 8' Uprights with pins that are pre-attached both sides to a 50mm X 50mm X 10' long square pole. Both ends are capped with a threaded, adjustable foot.

STEP 2: Insert caps into both ends of the pole.  
2.a) For the floor side, adjust the threaded foot by rotating the adjusting nut until the bottom of the foot measured to the bottom of the upright is 4".  
2.b) For the ceiling side, create as much slack as necessary so that the upright can be lifted to vertical position.

STEP 3: Raise the pole to vertical, orienting it in the direction desired. Position the bottom foot centered in the starting location. Using appropriate screws mount the bottom foot to the floor. The G.C. is to determine correct mounting hardware for the floor material. While one person holds the pole, another will level the pole.

STEP 4: On the ceiling side of the pole, tension the foot against the ceiling by screwing the adjusting nut. **Make sure there is blocking built in the ceiling for structure support.** Verify level one more time and then fully tension the top foot with a wrench. Using appropriate screws mount the top foot to the ceiling.

Level Upright Pole

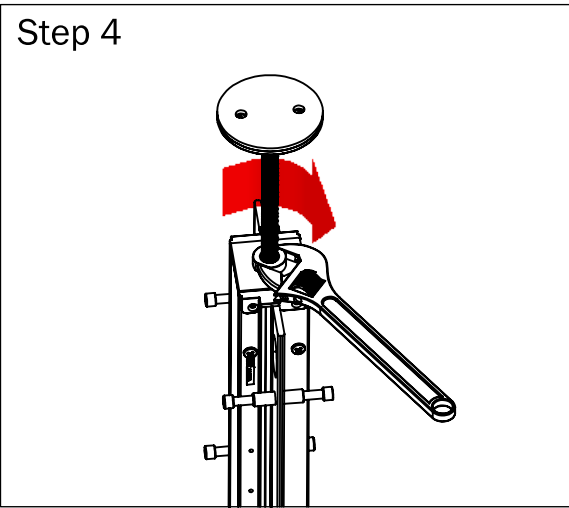
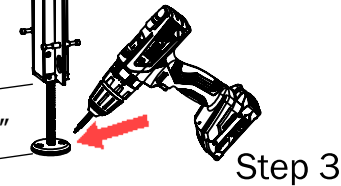

# MURO "FLOOR TO CEILING SETUP"

## INSTALLING 2ND UPRIGHT

PAGE  
3 of 7

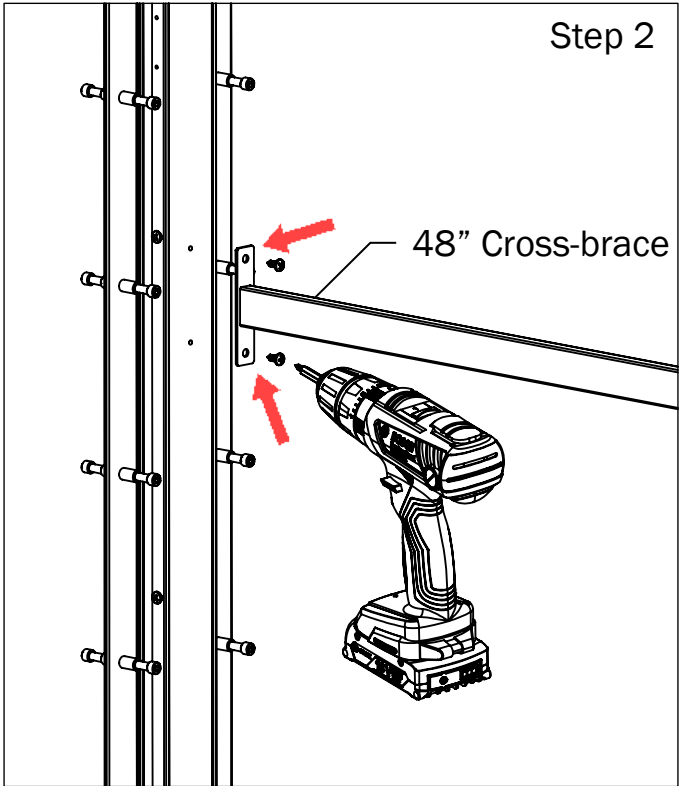
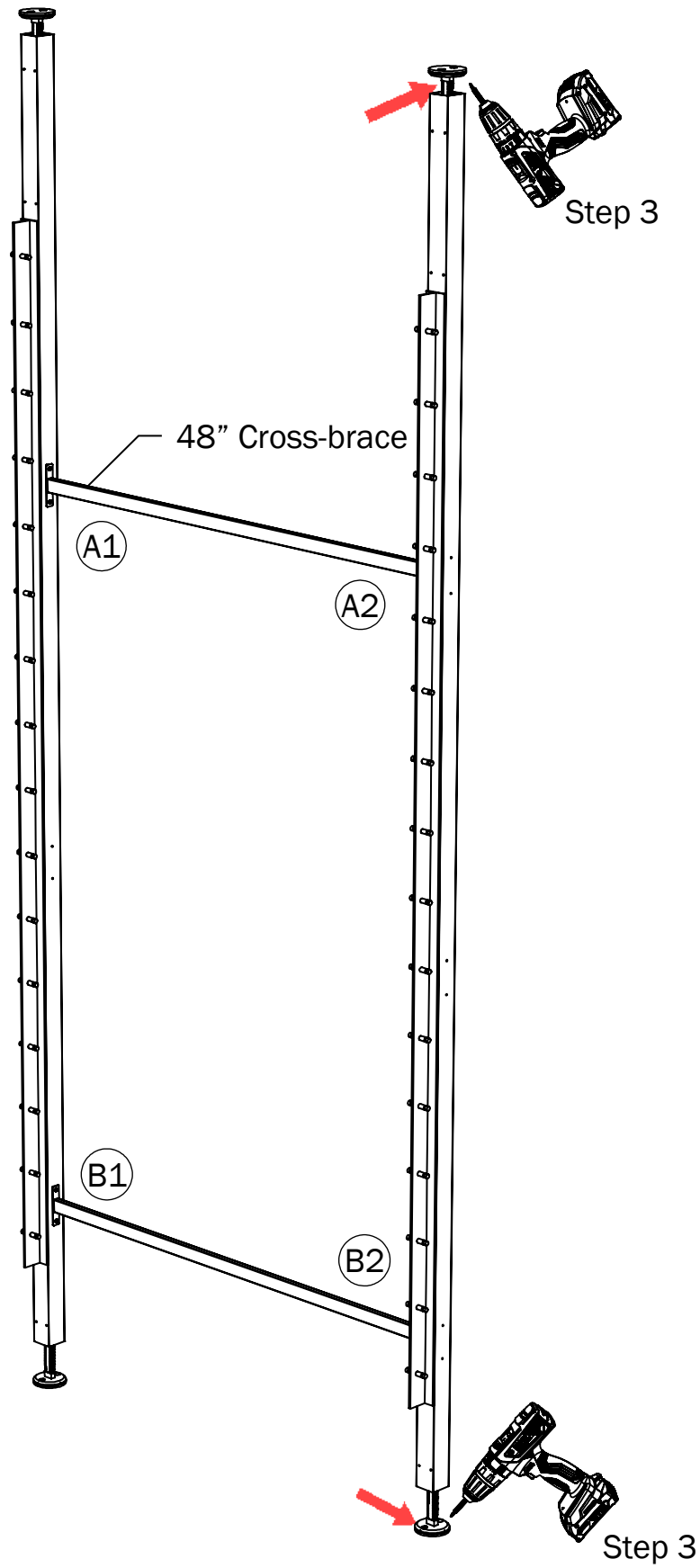

STEP 1: Setup the next upright pole similarly to the first, with the threaded foot measuring 4". Lift the upright pole vertically into approximate position, following the floor line marking.

STEP 2: Use (2) 48 inch cross-braces between the uprights for proper spacing. The poles have predrilled pilot holes (marked A and B in the diagram). While one person holds the 2nd pole vertically, another will attach the cross-braces to the poles with screws.

STEP 3: After all two cross-braces have been attached between both poles, position the 2nd pole into place. Again level the pole. Screw the foot to the floor, tension the top foot to the ceiling, and screw the top foot to the ceiling in a similar fashion as performed on the 1st upright.

# MURO "FLOOR TO CEILING SETUP"

## FINISH UPRIGHT INSTALL

STEP 1: Following the steps on the previous pages, set up the remaining upright poles. Use 24 inch cross-braces between the 2nd and 3rd poles. Remove the 48 inch cross-braces from 1st and 2nd poles and use them between the 3rd and 4th poles.

STEP 2: Once all done, remove all cross-braces.

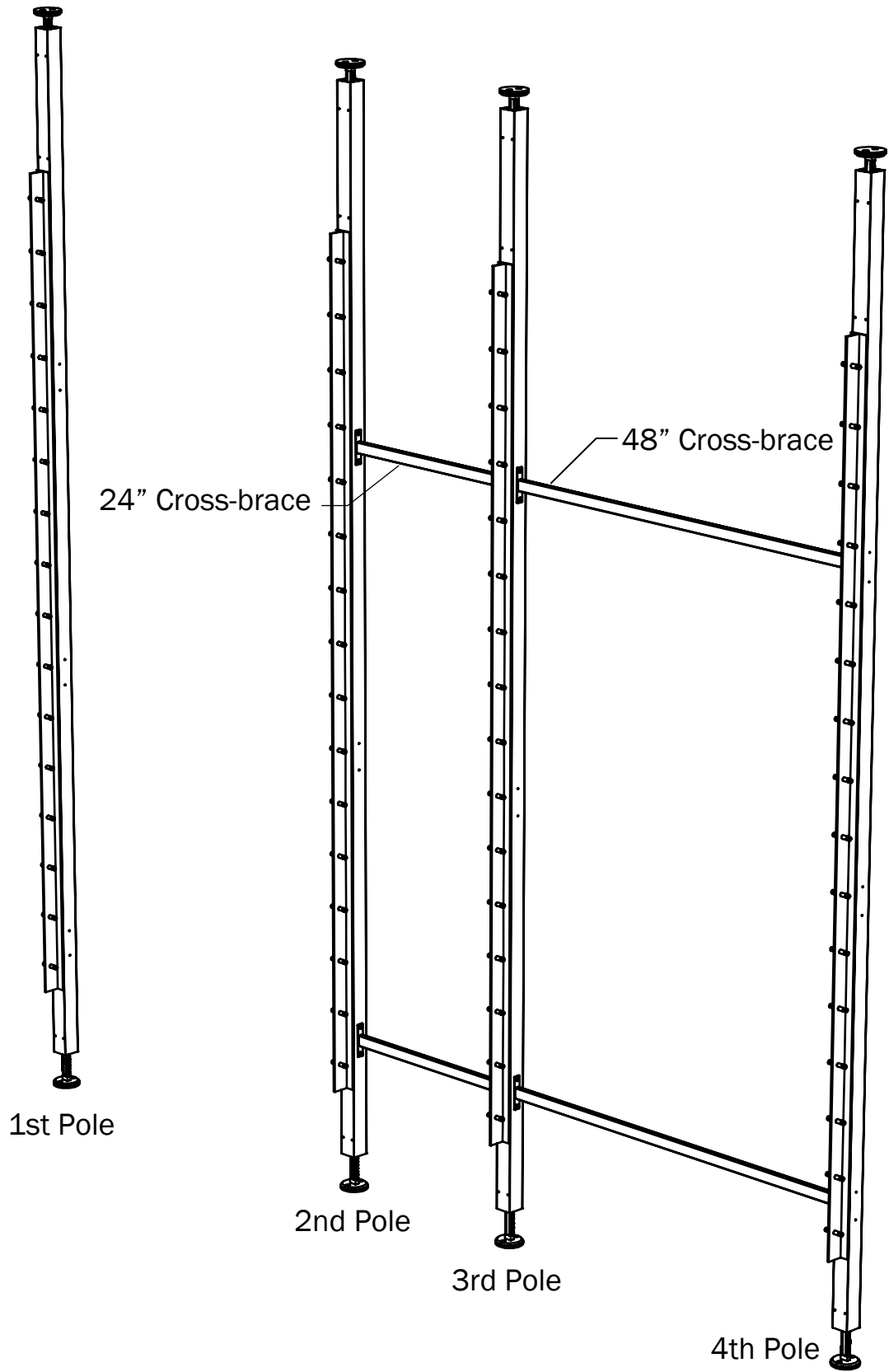

# MURO "FLOOR TO CEILING SETUP"

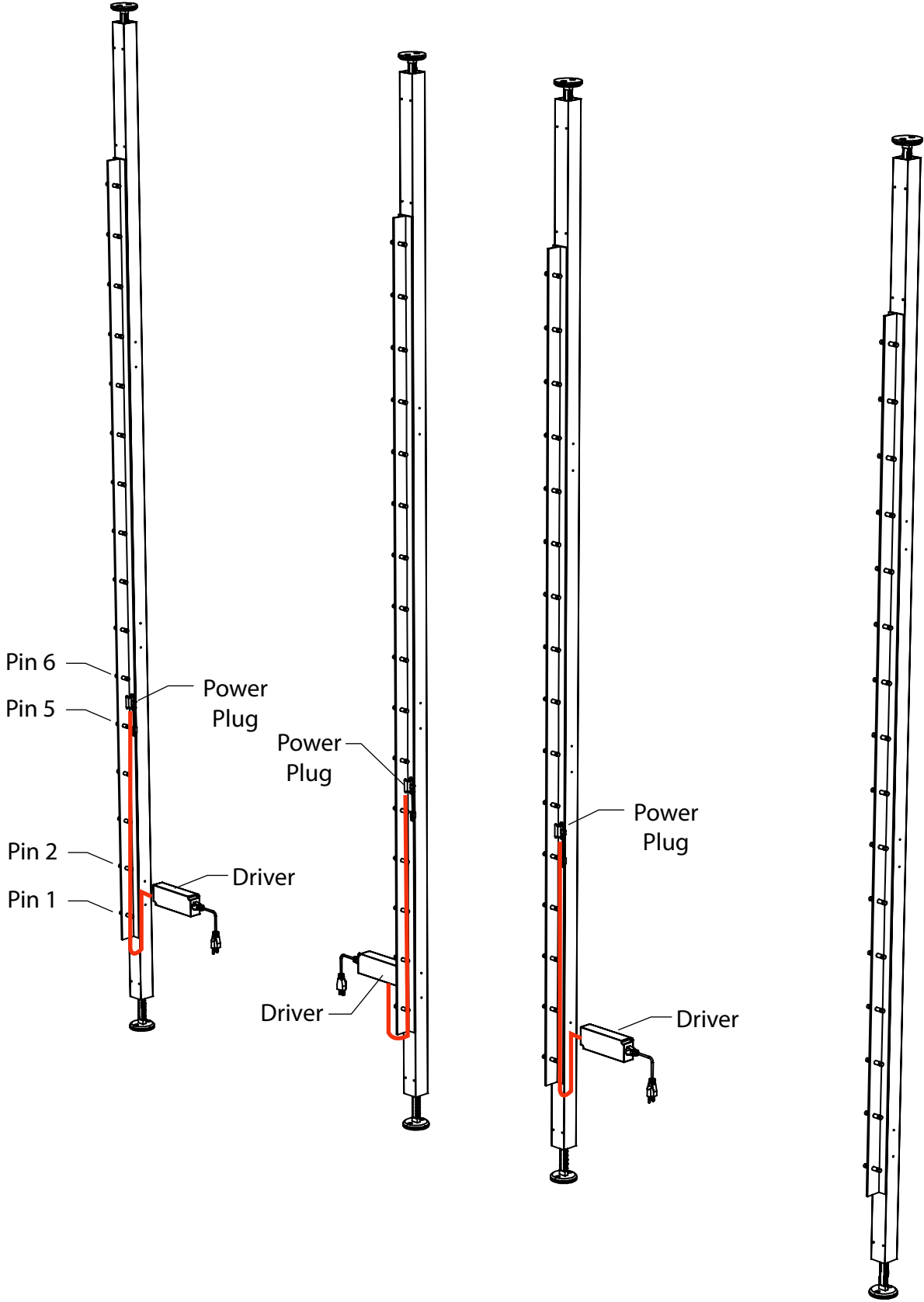

STEP 1: 3 Drivers are mounted to the wall between the upright poles as shown. The recommended height will be between pin 1 and 2.

STEP 2: Attach 3 power plugs to the upright as shown. The recommended location is between pin 5 and 6.

STEP 3: Route the cable from power plug down along the upright shown red. Then connect the cable to the driver.

STEP 4: Plug the driver power cord into the outlet.

# MURO "FLOOR TO CEILING SETUP"

## ADDING ENDCAPS

PAGE  
6 of 7

STEP 1: Orient the End Cap properly so that the spring clips face the upright pins. Simply push the spring clips on to the pins and the End Cap will snap into position. Make sure the End Cap hide the power connector cable.

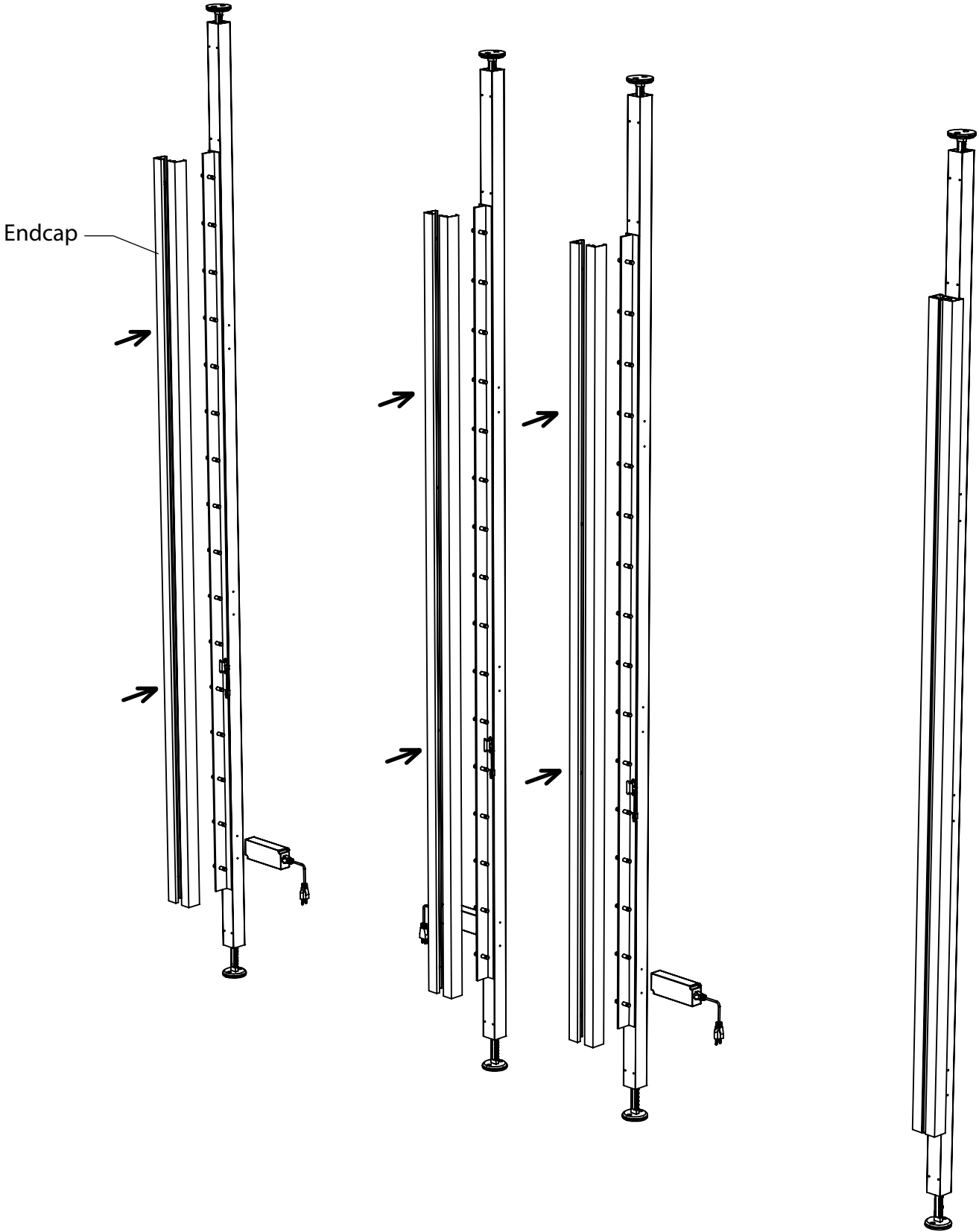

# MURO "FLOOR TO CEILING SETUP"

## ADDING ACCESSORIE

STEP 1: Attach all the accessories on to the uprights as shown.

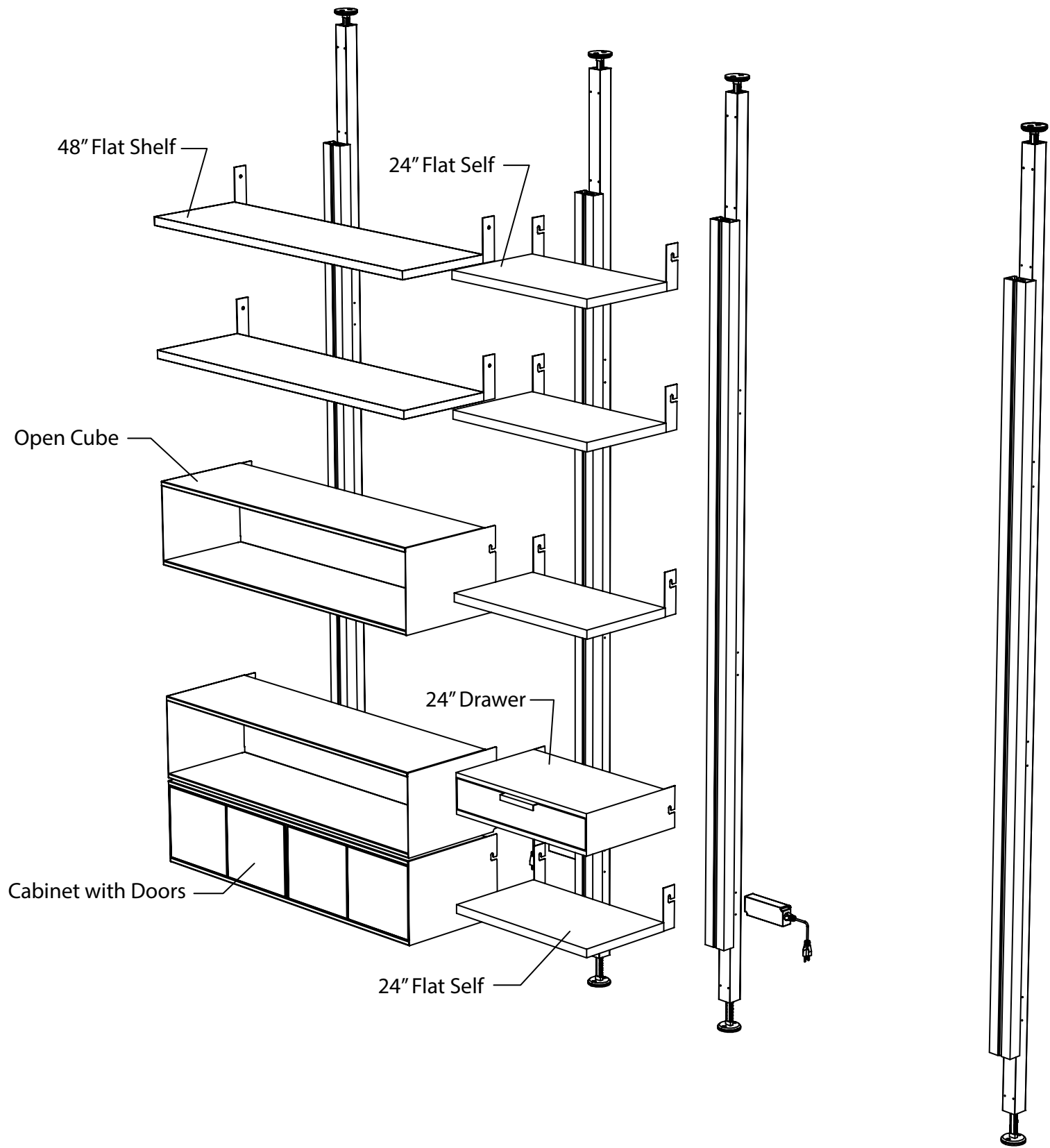



**Thank you for choosing  
the MURO SYSTEM!**



650.593.4127 [WWW.BNIND.COM](http://WWW.BNIND.COM)